

Bill No. 294
2022

By-law No. S.-____-____

A by-law to lay out, constitute, establish and assume certain reserves in the City of London as public highway. (as part of Southport Crescent; as widening to Southport Crescent and Chelton Road; as part of Evans Boulevard; as part of Candice Road; and as part of Fairchild Road)

WHEREAS section 5(3) of the Municipal Act, 2001, S.O. 2001, c.25, as amended, provides that a municipal power shall be exercised by by-law;

WHEREAS subsection 10(2) paragraph 7 of the Municipal Act, 2001, S.O. 2001, c.25, as amended, provides that a municipality may pass by-laws to provide any service or thing that the municipality considers necessary or desirable to the public;

WHEREAS subsection 31(2) of the Municipal Act, 2001, S.O. 2001, C.25, as amended, provides that land may only become a highway by virtue of a by-law establishing the highway and not by the activities of the municipality or any other person in relation to the land, including the spending of public money;

AND WHEREAS it is expedient to establish the lands hereinafter described as public highway;

NOW THEREFORE the Municipal Council of The Corporation of the City of London enacts as follows:

1. The lands and premises hereinafter described are laid out, constituted, established and assumed as public highway as part of Southport Crescent, namely:

“All of the 0.3m Reserve at the westerly limit of Southport Crescent on Registered Plan 33M-756, in the City of London and County of Middlesex, designated as Block 159 on Registered Plan 33M-756”; and

“All of the 0.3m Reserve at the northerly limit of Southport Crescent on Registered Plan 33M-789, in the City of London and County of Middlesex, designated as Block 64 on Registered Plan 33M-789.”

2. The lands and premises hereinafter described are laid out, constituted, established and assumed as public highway as widening to Southport Crescent and Chelton Road, namely:

“All of the 0.3m Reserve at the northerly limit of Southport Crescent on Registered Plan 33M-756 and the westerly limit of Chelton Road on Registered Plan 33M-756, in the City of London and County of Middlesex, designated as Block 160 on Registered Plan 33M-756.”

3. The lands and premises hereinafter described are laid out, constituted, established and assumed as public highway as part of Evans Boulevard:

“All of the 0.3m Reserve at the westerly limit of Evans Boulevard on Registered Plan 33M-789, in the City of London and County of Middlesex, designated as Block 61 on Registered Plan 33M-789.”

4. The lands and premises hereinafter described are laid out, constituted, established and assumed as public highway as part of Candice Road:

“All of the 0.3m Reserve at the northerly limit of Candice Road on Registered Plan 33M-789, in the City of London and County of Middlesex, designated as Block 62 on Registered Plan 33M-789.”

5. The lands and premises hereinafter described are laid out, constituted, established and assumed as public highway as part of Fairchild Road:

“All of the 0.3m Reserve at the northerly limit of Fairfield Road on Registered Plan 33M-789, in the City of London and County of Middlesex, designated as Block 63 on Registered Plan 33M-789.”

6. This by-law comes into force and effect on the day it is passed.

PASSED in Open Council on July 5, 2022.

Ed Holder
Mayor

Michael Schulthess
City Clerk

First Reading – July 5, 2022
Second Reading – July 5, 2022
Third Reading – July 5, 2022

Location Map

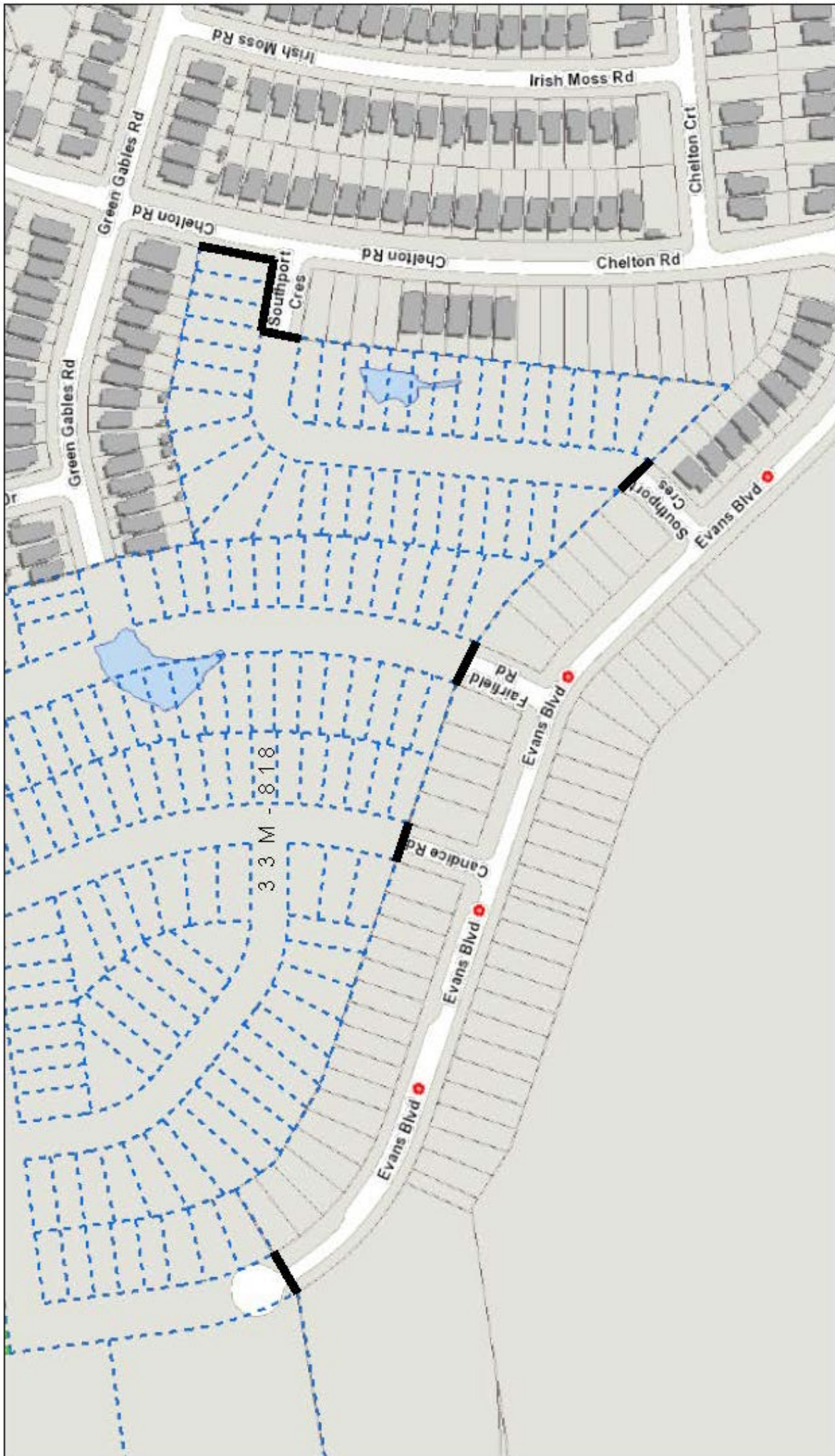

█ SUBJECT LANDS