



London  
CANADA

# Gibbons Park Playground Upgrade

Presentation to ACCAC  
April 28, 2022

[london.ca](http://london.ca)



# Gibbons Park Playground Location Map

Corporate City Map



4/25/2022 3:45:04 PM

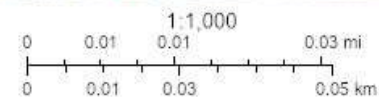

Gibbons Park, 2A Grosvenor St



London  
CANADA

# Playground Project

- Upgrade of East play area (5 to 12 age group - senior)
- Upgrade of West play area (2 to 5 age group - junior)
- Existing swing set to remain
- Safety surfacing will be engineered woodchips
- Creation of 2 'beach entry' ramp access points
- Upgrade of existing asphalt pathways

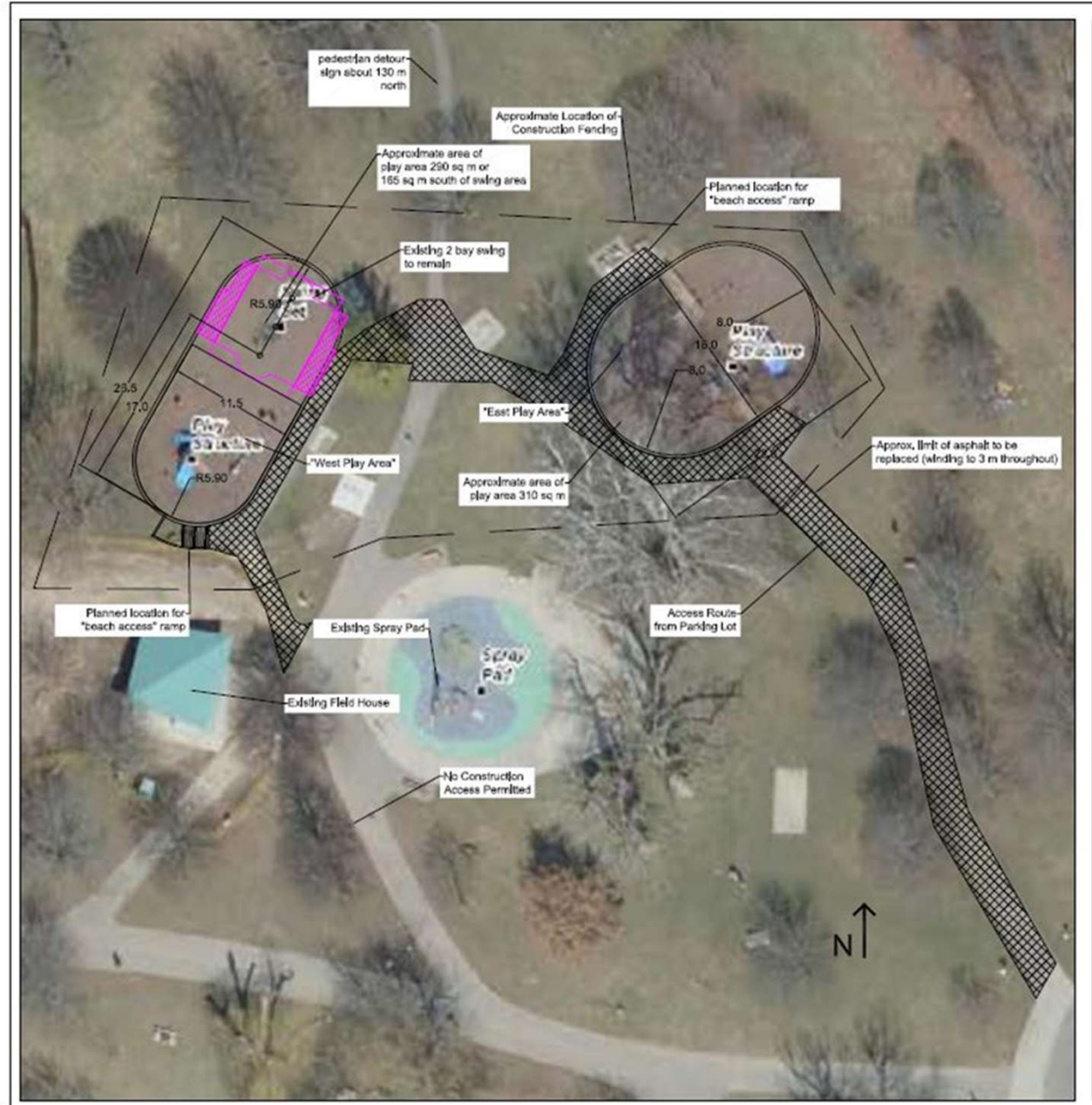



# Play equipment – East Area (5 to 12 age group - senior)



**CITY OF LONDON: GIBBONS PARK - OPTION #1**

**WWW.PARKPLAYDESIGN.COM**  
1-866-551-8188 042022 V2



[london.ca](http://london.ca)



# Play equipment – East Area (5 to 12 age group - senior)



**CITY OF LONDON: GIBBONS PARK - OPTION #1**  
london.ca

WWW.PARKNPLAYDESIGN.COM  
1-866-551-8188 042022 V4





# Play equipment – West Area (2 to 5 age group - junior)



CITY OF LONDON: GIBBONS PARK - OPTION #1

WWW.PARKNPLAYDESIGN.COM  
1-866-551-8188 042022 V6



[london.ca](http://london.ca)



# Play equipment – West Area (2 to 5 age group - junior)



CITY OF LONDON: GIBBONS PARK - OPTION #1

WWW.PARKNPLAYDESIGN.COM  
1-866-551-8188 042022 V7



[london.ca](http://london.ca)

SENIOR PLAY AREA  
297 SQM



SAFETY ZONE  
NON ENCRoACHMENT ZONE  
UNDER DECK COMPONENT



**CITY OF LONDON: GIBBONS PARK  
OPTION #1 SENIOR PLAY AREA**

Representative **MICHELLE POFFENROTH**

This play equipment is recommended for children ages **5 - 12**

Minimum Area Required:  
Scale: **1:100**  
This drawing can be scaled only when in an 11" x 17" format

**IMPORTANT:** Soft resilient surfacing should be placed in the use zones of all equipment, as specified for each type of equipment, and at depths to meet the critical fall heights as specified by the U.S. consumer Product Safety Commission, ASTM standard F 1487 and Canadian Standard CAN/CSA-Z-614-20

Drawn By: **MC**  
Date: **MARCH 18, 2022**  
Drawing Name: **OS2442**



JUNIOR PLAY AREA  
283 SQM



**CITY OF LONDON: GIBBONS PARK  
OPTION #1 JUNIOR PLAY AREA**

Representative **MICHELLE POFFENROTH**

This play equipment is recommended for children ages **18M - 5**

Minimum Area Required:  
Scale: 1:120  
This drawing can be scaled only when in an 11" x 17" format

**IMPORTANT:** Soft resilient surfacing should be placed in the use zones of all equipment, as specified for each type of equipment, and at depths to meet the critical fall heights as specified by the U.S. consumer Product Safety Commission, ASTM standard F 1487 and Canadian Standard CAN/CSA-Z-614-20

Drawn By: **MC**  
Date: **MARCH 18, 2022**  
Drawing Name: **OS2442**

