



SPA21-050: 1150 Fanshawe Park Road East



Stackhouse Developments (London) Inc.

September 20, 2021



London
CANADA

Development Proposal

STACKHOUSE AVENUE

FANSHAW PARK ROAD EAST

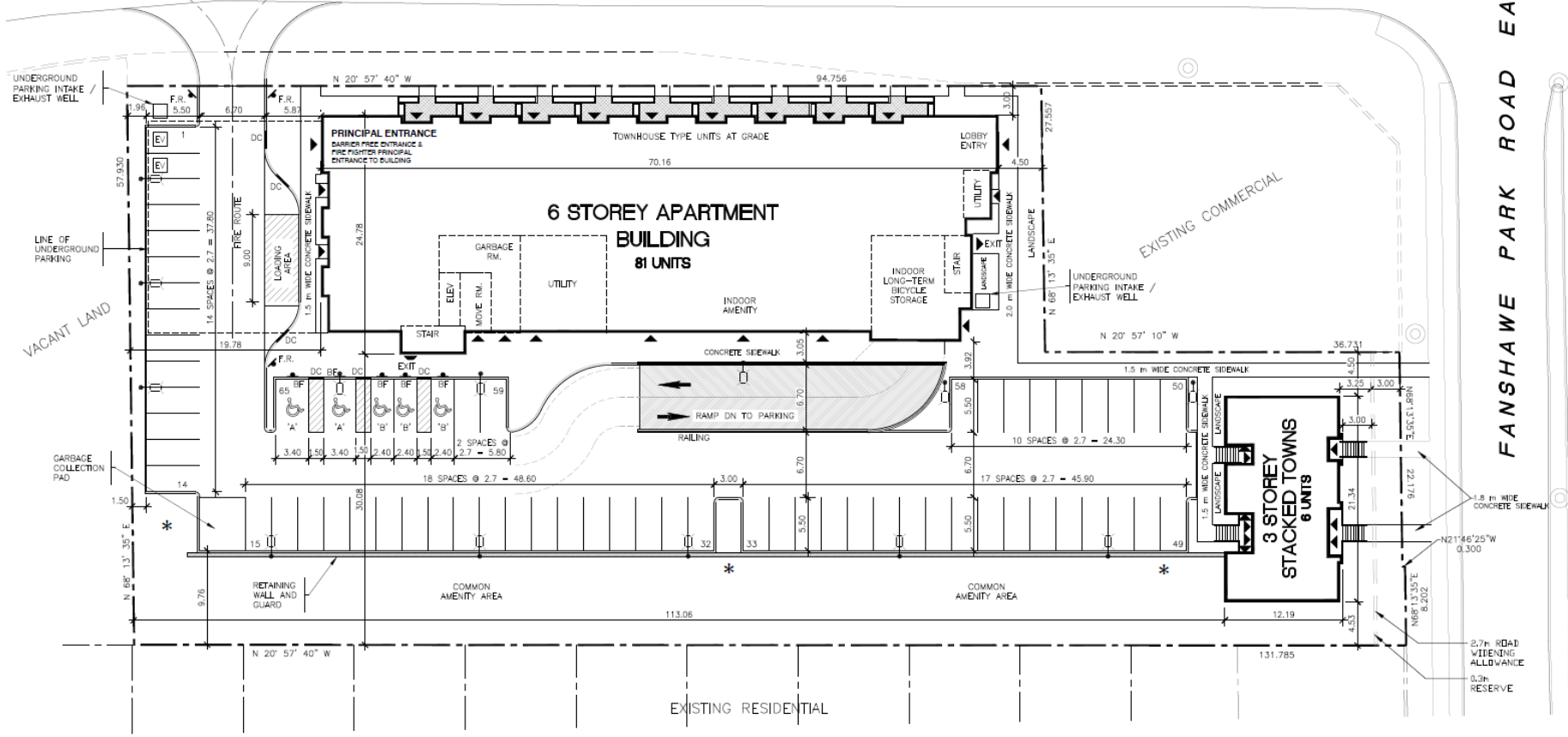



Development Proposal



North & East Apartment Building Elevations



Stacked Townhouse Elevations





Development Proposal

- Rezoned in 2020 to permit the proposed 6-storey, 81-unit apartment building and one, 3-storey stacked townhouse dwelling with 6 units
- Maximum Density: 133 units per hectare
 - Proposed: 133 units per hectare (87 units)
- Parking: 110 spaces required (minimum)
 - Conforms to the regulations of the Zoning By-law
 - Visitor parking will be provided
- Lot Coverage: 40% maximum
 - Proposed: 27.1%
- Landscape Open Space: 30% minimum required
 - Proposed: 38.5%



Council Resolution

- Garbage storage location
- Western property boundary fencing for screening
- Enhanced landscaping along the southwest property boundary for screening from the stacked townhouse dwellings
- Minimal or no windows to habitable rooms for the west façade of the stacked townhouses

