

Report to Civic Works Committee

To: Chair and Members
Civic Works Committee

From: Kelly Scherr, P.Eng., MBA, FEC, Managing Director,
Environmental & Engineering Services and City Engineer

Subject: Ministry of Transportation Road Closures for the Highway
401/Highway 4 (Colonel Talbot Road) Interchange
Improvements

Date: January 19, 2021

Recommendation

That on the recommendation of the Managing Director, Environmental & Engineering Services and City Engineer, the required municipal road closures related to the Highway 401 / Highway 4 (Colonel Talbot Road) interchange improvements and the Highway 4 and Glanworth Drive underpass bridge replacements **BE ENDORSED** in accordance with the approved Transportation Environmental Study Report prepared by the Ontario Ministry of Transportation (MTO).

Executive Summary

This report provides information on the planned Highway 401 / Highway 4 (Colonel Talbot Road) interchange improvements including the Glanworth Drive underpass replacement being managed by the Ministry of Transportation (MTO) and seeks endorsement of the required municipal road closures in the vicinity of the interchange to facilitate the improvements. MTO has undertaken an environmental assessment for the project which was approved August 31, 2020.

Linkage to the Corporate Strategic PlanThe following report supports the Strategic Plan through the strategic focus area of Building a Sustainable City and ensuring London's infrastructure is built, maintained and operated to meet the long term needs of our community.

Analysis

1.0 Background Information

1.1 Previous Reports Related to this Matter

- Environment and Transportation Committee – January 12, 2004 – Highway 401 Improvements: Planning Study Completion;
- Civic Works Committee – February 4, 2013 – Agreement with Ministry of Transportation; and,
- Civic Works Committee – March 19, 2018 – Endorsement of Environmental Assessment.

2.0 Context

MTO has undertaken an environmental assessment and created a Transportation Environmental Study Report (TESR) for improvements at the interchange of Highway 401 and Highway 4 (Colonel Talbot Road) including the Glanworth Drive underpass bridge. The TESR was initiated late in 2012 and included extensive consultation with the public including the residents in the area. The study was finalized and issued for public review on October 29, 2018 which closed on December 10, 2018. A Part II order request was encountered by the project. The Ministry of Environment, Conservation and Parks (MECP) approved the project on August 31, 2020.

MTO is now completing the preliminary design and moving into the detailed design phase. MTO will be retaining a design build team for the next phase in 2021.

Attached as Appendix A is an exhibit from MTO's planned submission to the Local Planning Appeal Tribunal (LPAT). The figure illustrates the approved layout for the interchange including revisions to road alignments in the area. The municipal roadways with changes to alignment include:

- Glanworth Drive;
- Littlewood Drive;
- Tempo Road; and,
- Burtwhistle Lane.

Also noted in Appendix A are the related six road closures as they impact the Provincial Controlled Access Highway (CAH) limit of MTO lands in the vicinity of the interchange. MTO will be applying to the LPAT for the approval of the closing of any road which comes under the provisions of Section 37(2) of the Public Transportation and Highway Improvement Act. Prior to the submission to LPAT, MTO is looking for the City's endorsement of the road closings.

3.0 Discussion and Considerations

The overall approval of the interchange improvements will include realignment of Glanworth Drive, Littlewood Drive, Tempo Road and Burtwhistle Lane as noted in Appendix A. As a result, MTO will require road closures of the original roadway alignments as noted.

The proposed road closures and associated roadway realignments will not result in any significant access issues for the residents and businesses located along these roadways. Local access issues have been addressed as part of the TESR.

Environmental & Engineering Services staff have reviewed the proposed road closures and support the closures as they will improve safety and operation of the interchange.

MTO will be responsible for acquiring all of the property, building the new realigned roads and associated infrastructure and for dedicating and transferring the completed road allowances to the City. The transfer to the City will be done through Order in Council (OIC), which will require a future report to municipal council for approval of the transfer by bylaw.

Conclusion

The approved reconfiguration of this interchange was informed by public consultation. The new design involves realignment of several roads to improve operations and safety. The procedure to realign the local roads involves a formal closing followed by the dedication of new road allowances when the property is available. An endorsement of the required road closures by MTO is recommended.

Prepared by: Garfield Dales, P.Eng., Division Manager, Transportation Planning and Design

Submitted by: Doug MacRae, P.Eng., MPA, Director, Roads and Transportation

Recommended by: Kelly Scherr, P.Eng., MBA, FEC, Managing Director and City Engineer







Attach: Appendix A: Exhibit "B" – LPAT Road Closings for LPAT Submission – GWP 3030-11-00

cc:

Gary Irwin
Karl Grabowski
Geddes Mahabir – MTO
Natalia Bartos – MTO

Appendix A: Exhibit “B” – LPAT Road Closings for LPAT Submission

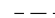
LEGEND:

-  INDICATES THOSE PORTIONS OF ROAD INTERSECTING OR RUNNING INTO A CONTROLLED-ACCESS HIGHWAY WHICH THE MINISTER OF TRANSPORTATION WISHES TO CLOSE PURSUANT TO THE PUBLIC TRANSPORTATION AND HIGHWAY IMPROVEMENT ACT.
-  M.T.O. INDICATES LANDS OWNED BY THE MINISTRY OF TRANSPORTATION AND NOT DESIGNATED AS A CONTROLLED-ACCESS HIGHWAY.
-  INDICATES OPEN ROADS.
-  INDICATES EXISTING EDGE OF PAVEMENT.
-  OUTLINES THE BOUNDARIES OF A HIGHWAY DESIGNATED AS A CONTROLLED-ACCESS HIGHWAY BY THE LIEUTENANT GOVERNOR IN COUNCIL, PURSUANT TO THE PROVISIONS OF THE PUBLIC TRANSPORTATION AND HIGHWAY IMPROVEMENT ACT.
-  INDICATES APPROXIMATE LOCATION OF PROPERTY LINES
-  INDICATES PROPOSED REALIGNMENT EDGE OF PAVEMENT
-  INDICATES PROPOSED REALIGNMENT RIGHT-OF-WAY

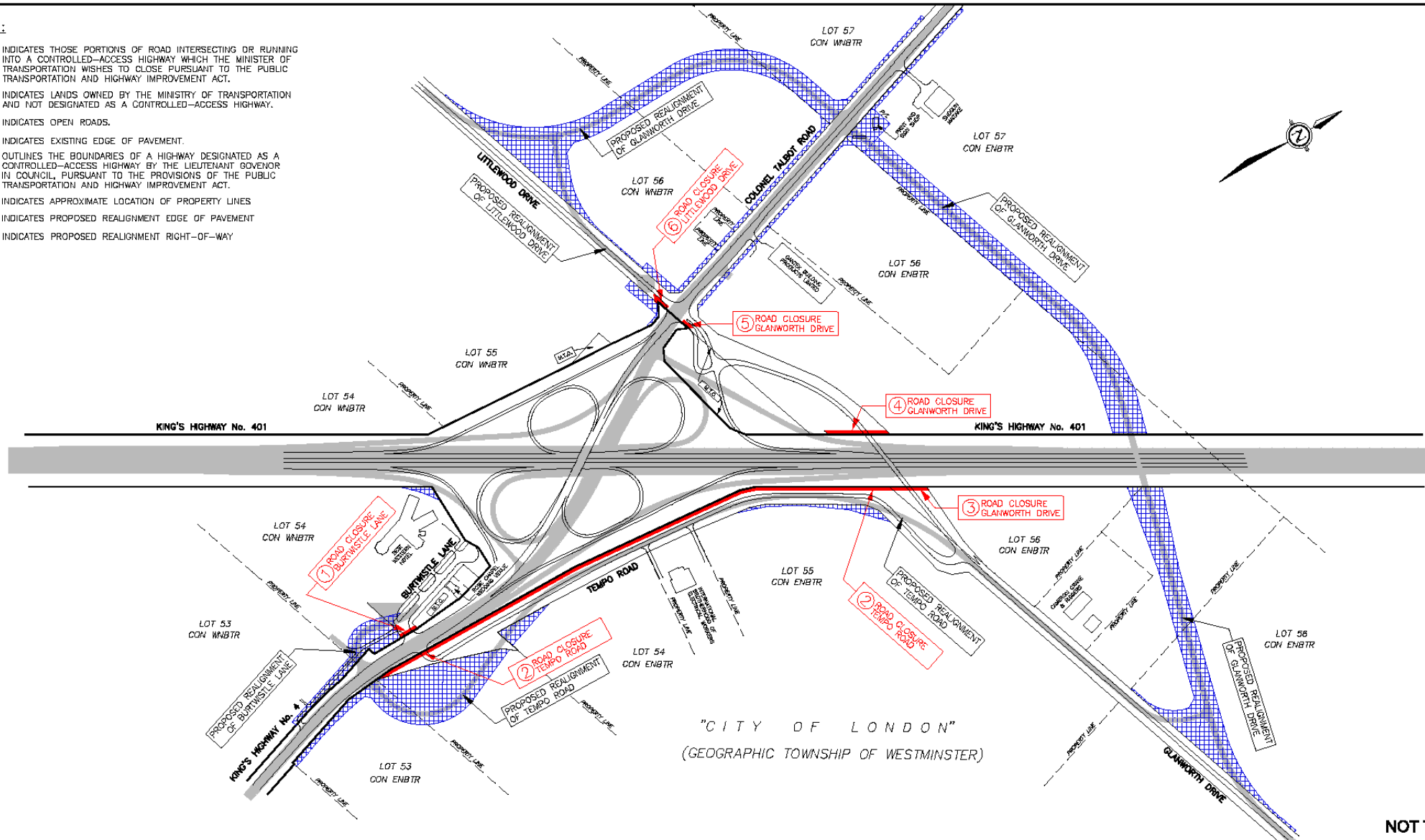

NOT TO SCALE



LPAT ROAD CLOSINGS - GWP 3030-11-00

LPAT ROAD CLOSINGS FOR TEMPO ROAD, BURTWISTLE LANE,
LITTLEWOOD DRIVE, AND GLANWORTH DRIVE

EXHIBIT
"B"