

Petition to stop the construction of a new sidewalk on Fox Mill Crescent

Re: Fox Mill Crescent, Fox Mill Grove, Fox Mill Court & Fox Mill Place Watermain Replacement Project

We, the residents of Fox Mill Crescent, petition the City of London to eliminate from the scope of the project, the installation of a sidewalk on Fox Mill Crescent.

This neighbourhood is approximately 55 years old. Many residents have lived on this crescent for more than 20 years. Our children have safely walked to the designated elementary and secondary schools, W. Sherwood Fox P.S. and Saunders S.S.

Fox Mill Crescent receives **minimal** pedestrian traffic! It is a very quiet street. Steeplechase Drive, which runs parallel to Fox Mill Crescent, already has sidewalks, is where the elementary school is located and is where the bulk of use occurs.



We, the residents of Fox Mill Crescent, do not feel there is a need for a sidewalk on our quiet Crescent. Furthermore, we will be losing many of our beautiful trees due to the replacement of the watermain. Suffering the additional loss of six feet of property frontage, to accommodate an unwanted and unrequired sidewalk, is a tragedy. This will seriously affect the quality of our lives, and is sure to have an impact on property value.

Dated: February 22, 2020

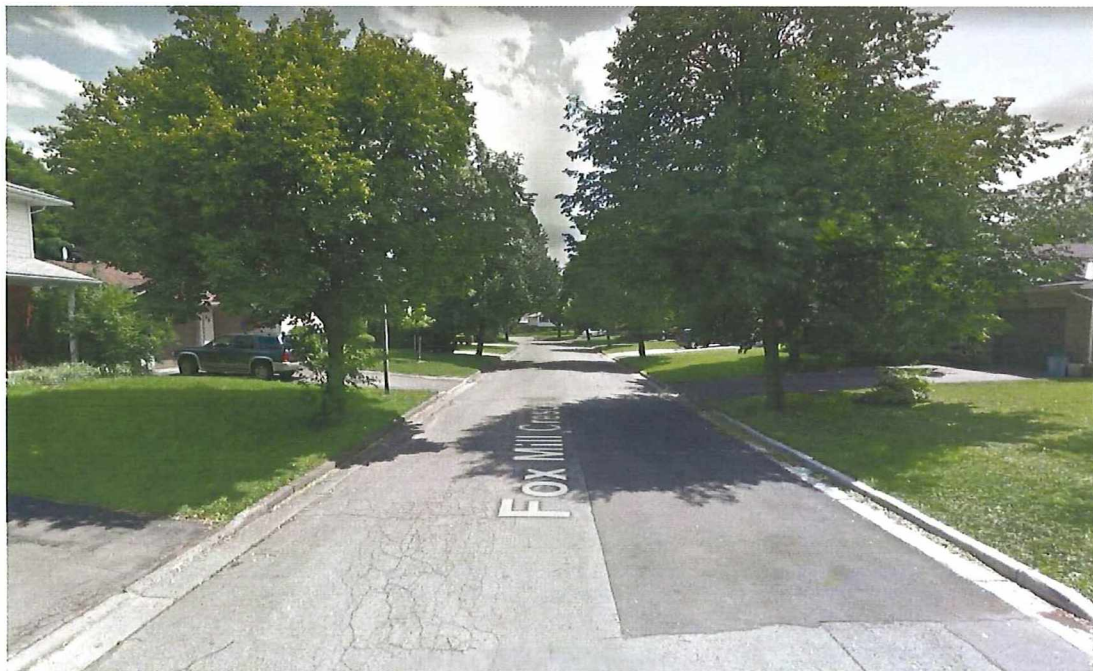
Photos of Existing Conditions



LEGEND

-  TREE TO BE REMOVED
-  PROPOSED 1.8 m SIDEWALK

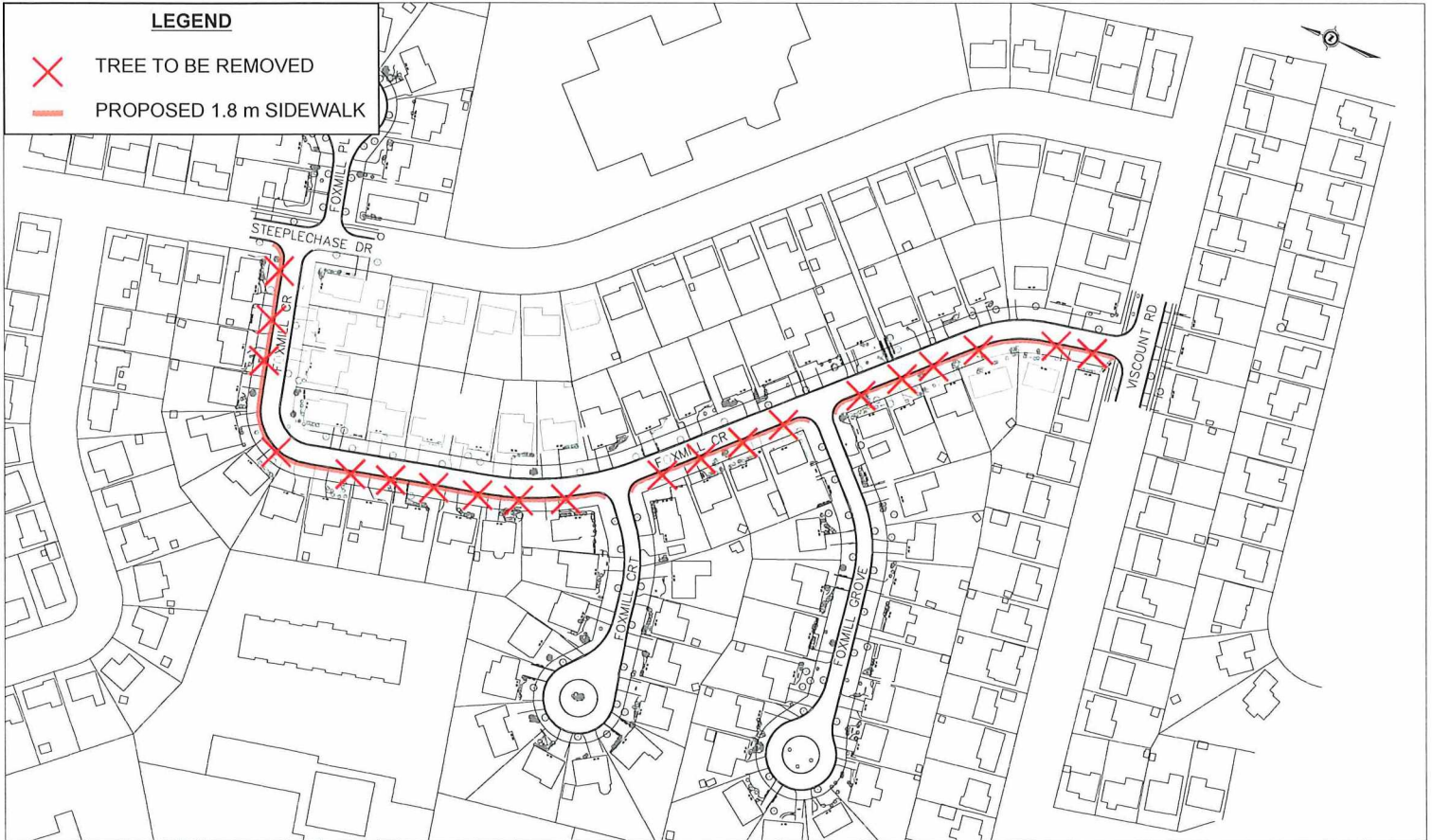

EXISTING SERVICES	DRAWING #	SOURCE	DATE	CONSTRUCTED SERVICES	COMPLETION	DETAILS	NL	REVISIONS	DATE	CONSULTANT

ENVIRONMENTAL & ENGINEERING SERVICES



NOT TO SCALE

2020 ANNUAL ROAD RECONSTRUCTION PROGRAM
FOX MILL CR

2020 LOCAL
1 OF 1