

Bill No. 67  
2020

By-law No. S.-\_\_\_\_-\_\_\_\_

A by-law to lay out, constitute, establish and assume lands in the City of London as public highway. (as widening to Southdale Road West, east of Tillmann Road)

WHEREAS it is expedient to establish the lands hereinafter described as public highway;

NOW THEREFORE the Municipal Council of The Corporation of the City of London enacts as follows:

1. The lands and premises hereinafter described are laid out, constituted, established and assumed as public highway as widening to Southdale Road West, east of Tillmann Road, namely:

Part of Block 141 on Registered Plan 33M-621 in the City of London and County of Middlesex, designated as Parts 1, 2 and 3 on Reference Plan 33R-20570; and

Part of Lot 78, Concession East of the North Branch of the Talbot Road, in the geographic Township of Westminster, now in the City of London and County of Middlesex, designated as Parts 8, 9, 12, 13, 16 and 19 on Reference Plan 33R-20570; and;

All of Block 142 on Registered Plan 33M-621 in the City of London and County of Middlesex.

2. This by-law comes into force and effect on the day it is passed.

PASSED in Open Council on January 28, 2020.

Ed Holder  
Mayor

Catharine Saunders  
City Clerk

First Reading - January 28, 2020  
Second Reading - January 28, 2020  
Third Reading - January 28, 2020

# LOCATION MAP

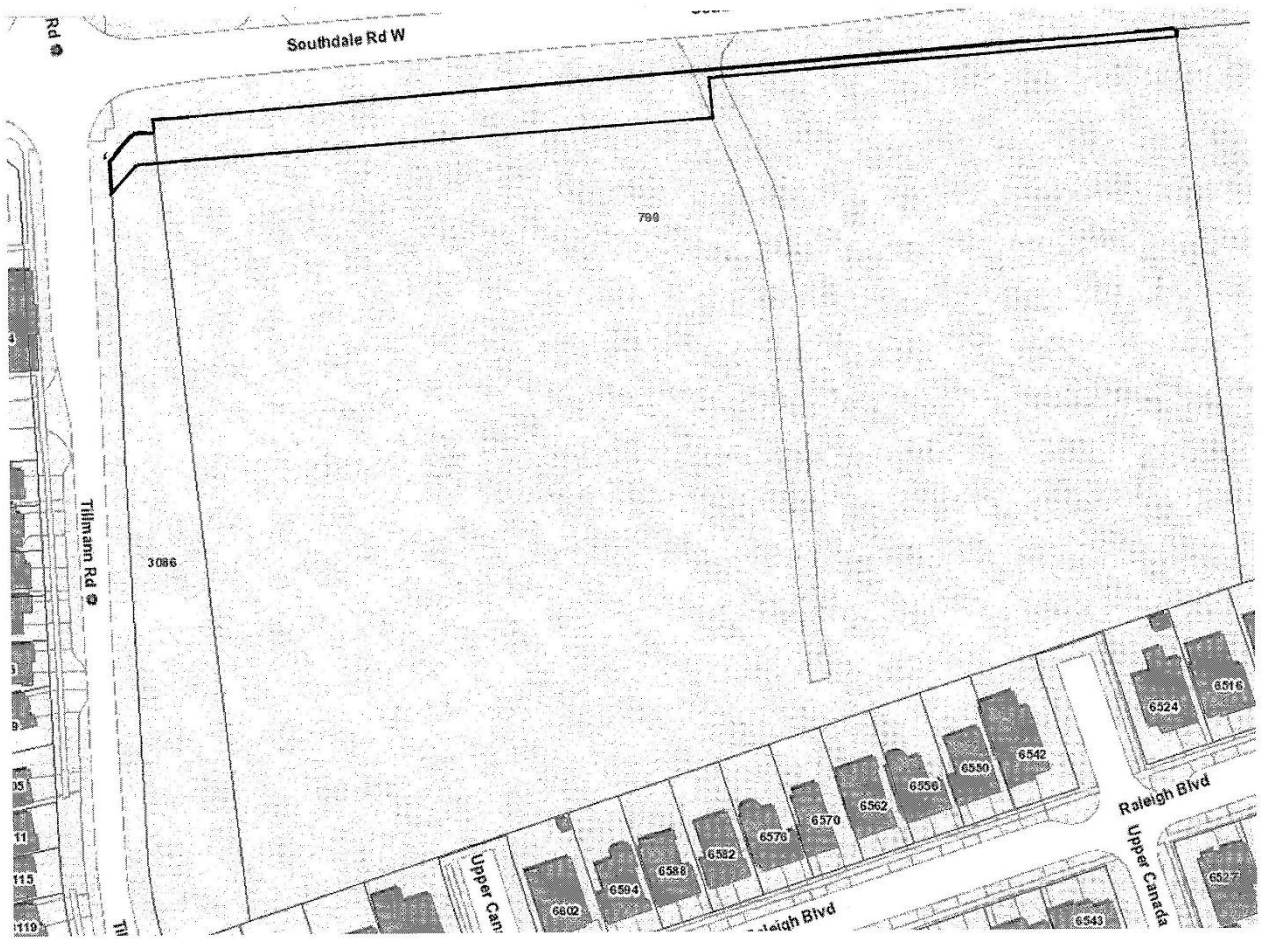

 SUBJECT LANDS