

Bill No. 36
2020

By-law No. S.-_____ - ____

A by-law to assume certain works and services
in the City of London. (Richmond North
Subdivision – Phase 2; Plan 33M-703)

WHEREAS the Managing Director, Environmental & Engineering Services
and City Engineer of The Corporation of the City of London has reported that works and
services have been constructed to his satisfaction in Richmond North Subdivision –
Phase 2; Plan 33M-703;

AND WHEREAS it is deemed expedient to assume the said works and
services;

NOW THEREFORE the Municipal Council of The Corporation of the City
of London enacts as follows:

1. The Corporation of the City of London assumes the following works and
services, namely:

Richmond North Subdivision – Phase 2; Plan 33M-703
Sunningdale Developments Inc. c/o Auburn Developments Inc.

Torrey Pines Way – All;
McWade Place – All;
Parkland, Block 53 – All

2. The warranty period for the works and services in the subdivision referred
to in Section 1 of this by-law is for the period of December 11, 2019 to December 12,
2020.

3. This by-law comes into force and effect on the day it is passed.

PASSED in Open Council on January 14, 2020.

Ed Holder
Mayor

Catharine Saunders
City Clerk

First Reading – January 14, 2020
Second Reading – January 14, 2020
Third Reading – January 14, 2020

Assumption Limits



Assumption Limits Richmond North Subdivision Phase 2, Plan 33M-703

Assumption Limits:
Torry Pines Way - All;
McWade Place - All;
Parkland, Block 53 - All;

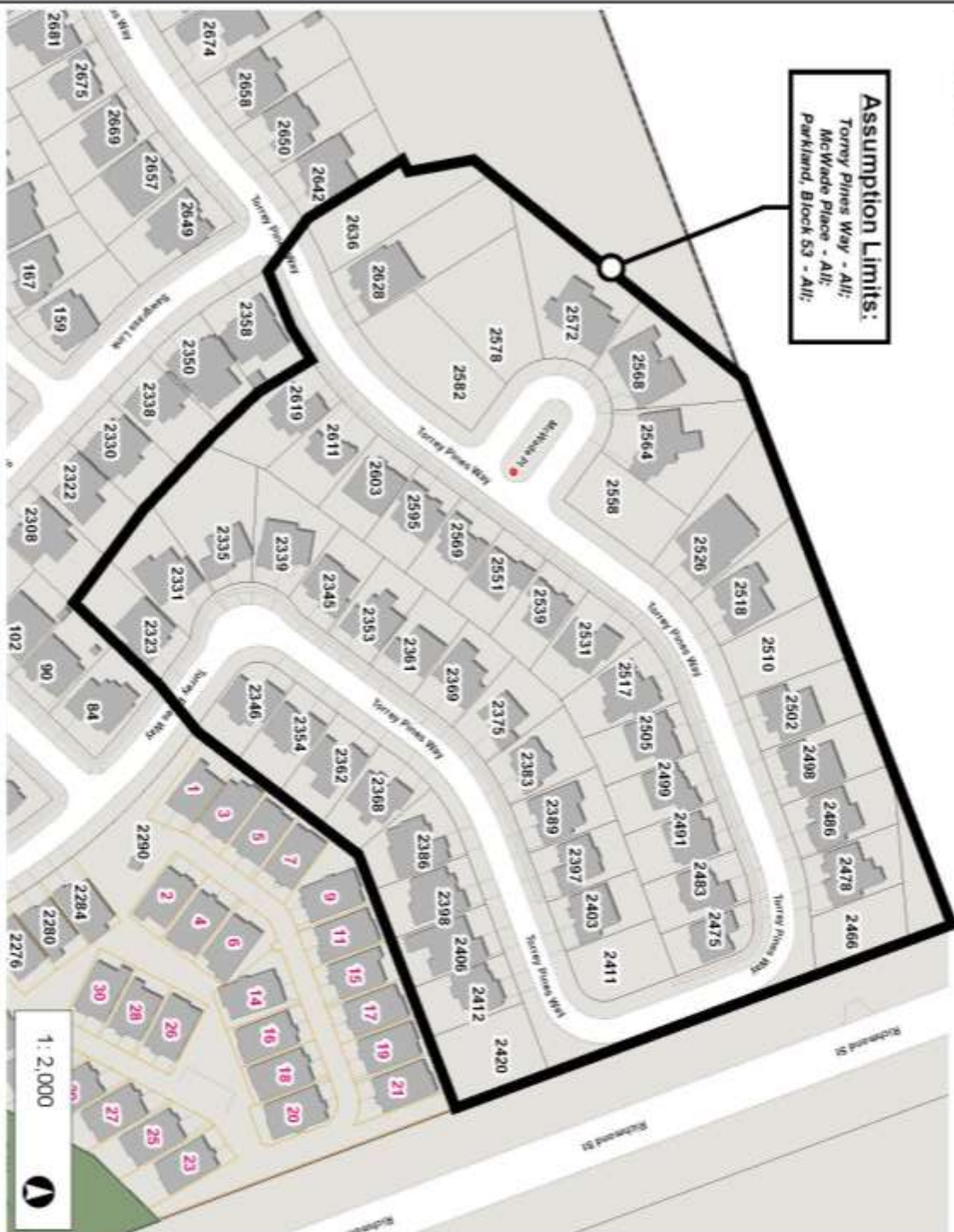

NAD_1983_UTM_Zone_17N
City of London

0 0.05 0.1 Kilometers

This map is a user generated static output from city of london site and is for reference only.

THIS MAP IS NOT TO BE USED FOR NAVIGATION

1:2,000

Notes