

Nov 16, 2019

attention Josh Morgan @ ward 007



re : FILE INFORMATION RECEIVED # Z-9108

JOSH : A FEW CONCERNS AS FOLLOWS :

>THE POPULATION DENSITY THAT MAY RESULT IS A RED HERRING , AFTER THE CONDOS ARE BUILT , WE WILL NEVER KNOW THE REAL DENSITY THAT RESULTS

>THE BUILDER SHOULD KNOW WHEN HE BOUGHT THE LOT THE SIZE AND SHOULD WORK WITH IN IT, I KNOW THEY HAVE RIGHTS TO MANIPULATE THE SYSTEM TO GET VARIANCES, THATS WHY WE ARE IN THIS DISCUSSION NOW

>I CANNOT ATTEND THE DEC 2 MEETING I WILL AWAY.

>I ENCLOSED THE SITE PLAN COPY I RECIEVED AND MADE NOTES OF CHANGES , THAT BUILDING OF 3 UNITS SHOULD BE ELIMINATED OR TURNED INWARD OR EVEN ATTACHED TO THE OTHER LONG FANCY ROW

>PERHAPS THAT SPACE COULD BE A PLAY GROUND OR MORE PARKING OR A PARKETTE . BUT BEING CLOSER THAN ALLOWED now by rules in place IS NOT A GOOD OPTION

>LAST BUT NOT LEAST A SPEED BUMP CLOSE TO THE INTERSECTION AS

**ANOTHER experiment WOULD BE FUN SINCE THEY ARE NOT ALLOWED
SOUTH OF FANSHAWE RD ON STREETS COMMENCING WITH 'A'**

**THANKS FOR YOUR ADVOCATING FOR RESONED DEVELOPMENT IN THIS
N/W QUADRANT OF LONDON**

SINCERELY

A handwritten signature in black ink, appearing to read "Robert Webb", with a long, sweeping horizontal flourish extending to the right.

ROBERT WEBB @ 1788 ALDERSBROOK RD

enclosed 1 page

emergency care facilities; converted dwellings; and small-scale nursing homes, rest homes and homes for the aged as the main uses.

The subject lands are in the Neighbourhoods Place Type in *The London Plan*, permitting a range of low-rise residential uses, including townhouses.

How Can You Participate in the Planning Process?

You have received this Notice because someone has applied to change the zoning of land located within 120 metres of a property you own, or your landlord has posted the public meeting notice in your building. The City reviews and makes decisions on such planning applications in accordance with the requirements of the *Planning Act*. If you previously provided written or verbal comments about this application, we have considered your comments as part of our review of the application and in the preparation of the planning report and recommendation to the Planning and Environment Committee. The additional ways you can participate in the City's planning review and decision making process are summarized below. For more detailed information about the public process, go to the [Participating in the Planning Process](#) page at [london.ca](#).

See More Information

You can review additional information and material about this application by:

- visiting Development Services at 300 Dufferin Ave, 6th floor, Monday to Friday between 8:30am and 4:30pm;
- contacting the City's Planner listed on the first page of this Notice; or
- viewing the application-specific page at [london.ca/planapps](#).

Attend This Public Participation Meeting

The Planning and Environment Committee will consider the requested zoning changes at this meeting, which is required by the *Planning Act*. You will be invited to provide your comments at this public participation meeting. A neighbourhood or community association may exist in your area. If it reflects your views on this application, you may wish to select a representative of the association to speak on your behalf at the public participation meeting. The Planning and Environment Committee will make a recommendation to Council, which will make its decision at a future Council meeting.

What Are Your Legal Rights?

Notification of Council Decision

If you wish to be notified of the decision of the City of London on the proposed zoning by-law amendment, you must make a written request to the City Clerk, 300 Dufferin Ave., P.O. Box 5035, London, ON, N6A 4L9, or at docservices@london.ca. You will also be notified if you speak to the Planning and Environment Committee at the public meeting about this application and leave your name and address with the Secretary of the Committee.

Right to Appeal to the Local Planning Appeal Tribunal

If a person or public body would otherwise have an ability to appeal the decision of the Council of the Corporation of the City of London to the Local Planning Appeal Tribunal but the person or public body does not make oral submissions at a public meeting or make written submissions to the City of London before the by-law is passed, the person or public body is not entitled to appeal the decision.

If a person or public body does not make oral submissions at a public meeting or make written submissions to the City of London before the by-law is passed, the person or public body may not be added as a party to the hearing of an appeal before the Local Planning Appeal Tribunal unless, in the opinion of the Tribunal, there are reasonable grounds to do so.

For more information go to <http://elto.gov.on.ca/tribunals/lpat/about-lpat/>.

Notice of Collection of Personal Information

Personal information collected and recorded at the Public Participation Meeting, or through written submissions on this subject, is collected under the authority of the *Municipal Act*, 2001, as amended, and the *Planning Act*, 1990 R.S.O. 1990, c.P.13 and will be used by Members of Council and City of London staff in their consideration of this matter. The written submissions, including names and contact information and the associated reports arising from the public participation process, will be made available to the public, including publishing on the City's website. Video recordings of the Public Participation Meeting may also be posted to the City of London's website. Questions about this collection should be referred to Cathy Saunders, City Clerk, 519-661-CITY(2489) ext. 4937.

Accessibility – Alternative accessible formats or communication supports are available upon request. Please contact accessibility@london.ca or 519-661-CITY(2489) extension 2425 for more information.

Site Concept

ELIMINATE AND CREATE "GREEN SPACE"
OR - TURN IT INWARD AS
1 OR 2 UNITS

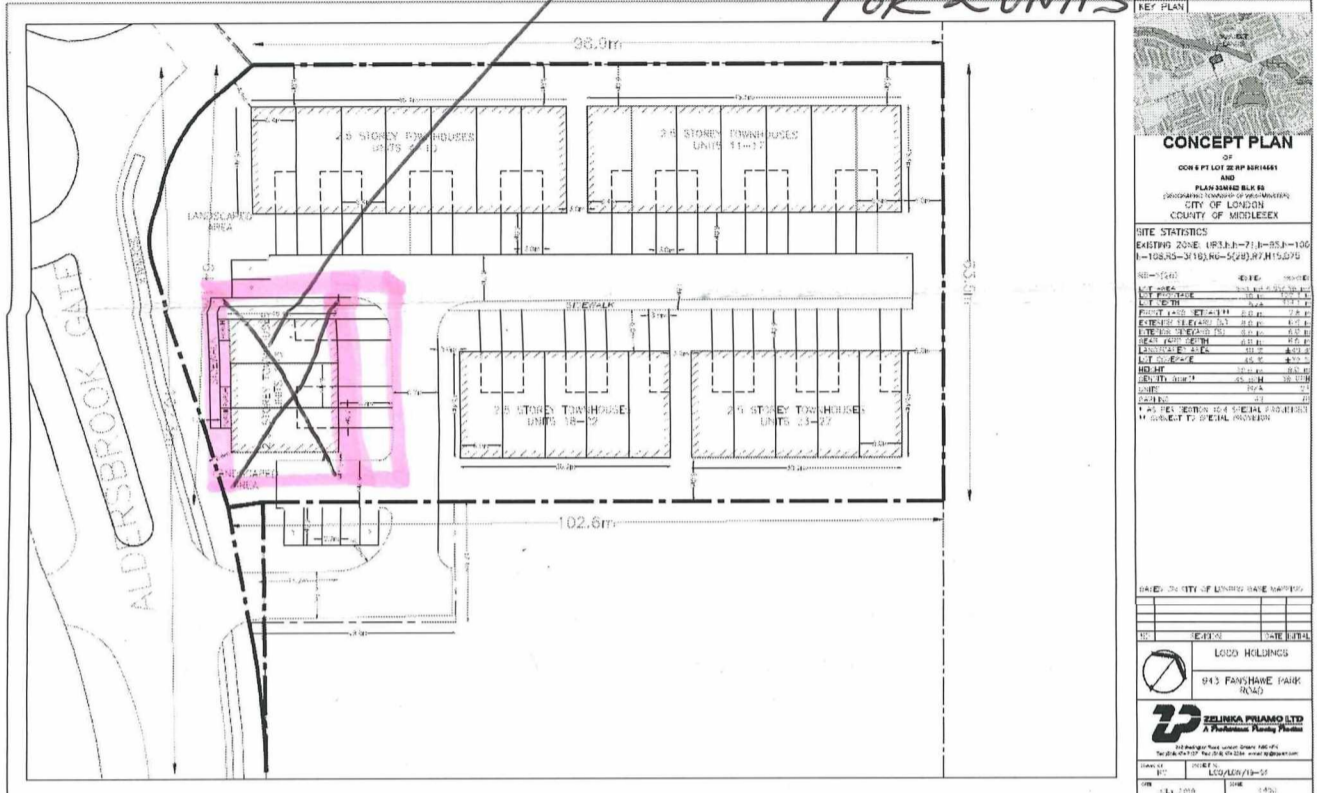

Conceptual Site Plan

Building Renderings



Conceptual Rendering

The above images represent the applicant's proposal as submitted and may change.

I THINK IT IS
3 UNITS - TOO
CLOSE TO ALD. GATE
ROADWAY!
(SEE ABOVE NOTES)