

Bill No. 412  
2019

By-law No. S.-\_\_\_\_-\_\_\_\_

A by-law to lay out, constitute, establish and assume certain reserves in the City of London as public highway. (as part of Silverfox Drive) (as part of Bridgehaven Drive)

WHEREAS it is expedient to establish the lands hereinafter described as public highway;

NOW THEREFORE the Municipal Council of The Corporation of the City of London enacts as follows:

1. The lands and premises hereinafter described are laid out, constituted, established and assumed as public highway as part of Silverfox Drive and as part of Bridgehaven Drive, namely:

“All of Block 117 on Registered Plan 33M-729 in the City of London and County of Middlesex.”

And

“All of Block 140 on Registered Plan 33M-750 in the City of London and County of Middlesex.”

2. This by-law comes into force and effect on the day it is passed.

PASSED in Open Council on October 29, 2019.

Ed Holder  
Mayor

Catharine Saunders  
City Clerk

First Reading – October 29, 2019  
Second Reading – October 29, 2019  
Third Reading – October 29, 2019

# Location Map

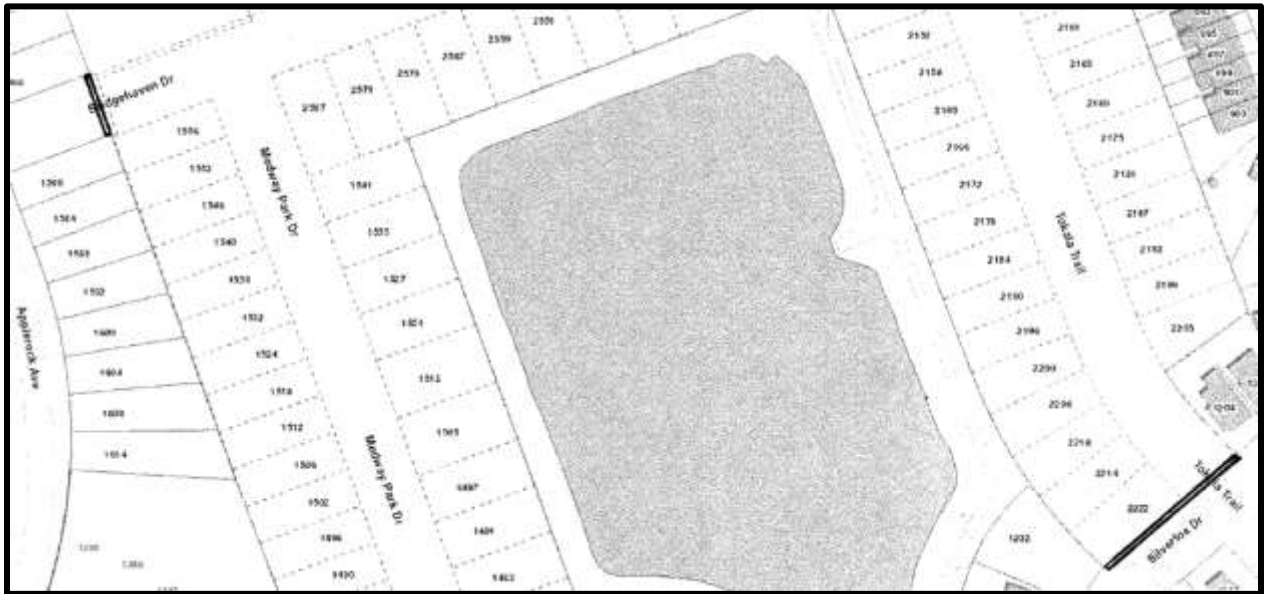

 Subject Lands