

**Adelaide Street North Municipal Class Environmental Assessment Study****Notice of Public Information Centre No. 2**

The City of London is undertaking a Municipal Class Environmental Assessment (EA) Study for the widening of Adelaide Street North according to the recommendations in the City's *Smart Moves Transportation Master Plan* (TMP). The study area includes Adelaide Street North from Fanshawe Park Road East to 350m north of Sunningdale Road East; including Sunningdale Road East from Blackwater Road to Stoney Creek Community Centre entrance. This project is being carried out under the planning and design process for a Schedule C project as outlined in the Municipal Engineers Association's *Municipal Class Environmental Assessment (October 2000, as amended in 2007, 2011 and 2015)*.

Public consultation is a key element of the EA planning process, and the second Public Information Centre (PIC) to share study details with the public is scheduled for:

Date: Wednesday, June 5, 2019

Time: 5:00 pm – 7:00 pm

Location: A. B. Lucas Secondary School
656 Tennent Avenue
London, ON, N5X 1L8

For those taking London Transit, local routes 16 and 40 are accessible by a short walking distance from the PIC venue.

The PIC will be held as a drop-in format, where attendees can freely browse the display boards, which will be used to present and obtain feedback on:

- The alternative design concepts and evaluation criteria;
- The preliminary preferred alternative design concept; and,
- Potential impacts and mitigation measures.

Following the PIC, in consideration of the comments received, the project team will confirm the preferred alternative design concept. Afterwards, an Environmental Study Report (ESR), which documents the EA process undertaken, will be compiled and made available for 30-day public review.

For more information, to provide comments, or to be added to the mailing list, please visit <http://www.london.ca/residents/environment/EAs/Pages/default.aspx> or contact:

Henry Huotari, Project Manager
Parsons Inc.
1069 Wellington Road South, Suite 214
London, ON N6E 2H6
Tel: 519-286-5517
Email: henry.huotari@parsons.com

Matt Davenport, Project Manager
City of London
300 Dufferin Avenue, 6th Floor, P.O Box 5035
London, ON N6A 4L9
Tel: 519-661-2489 x5232
Email: mdavenport@london.ca

Information collected for the study will be used in accordance with the Municipal Freedom of Information and Protection of Privacy Act. Except for personal information, including your name, address and property location, all comments received throughout the study will become part of the public record and included in project documentation.

ADELAIDE STREET NORTH
MUNICIPAL CLASS ENVIRONMENTAL ASSESSMENT
STUDY AREA KEY MAP

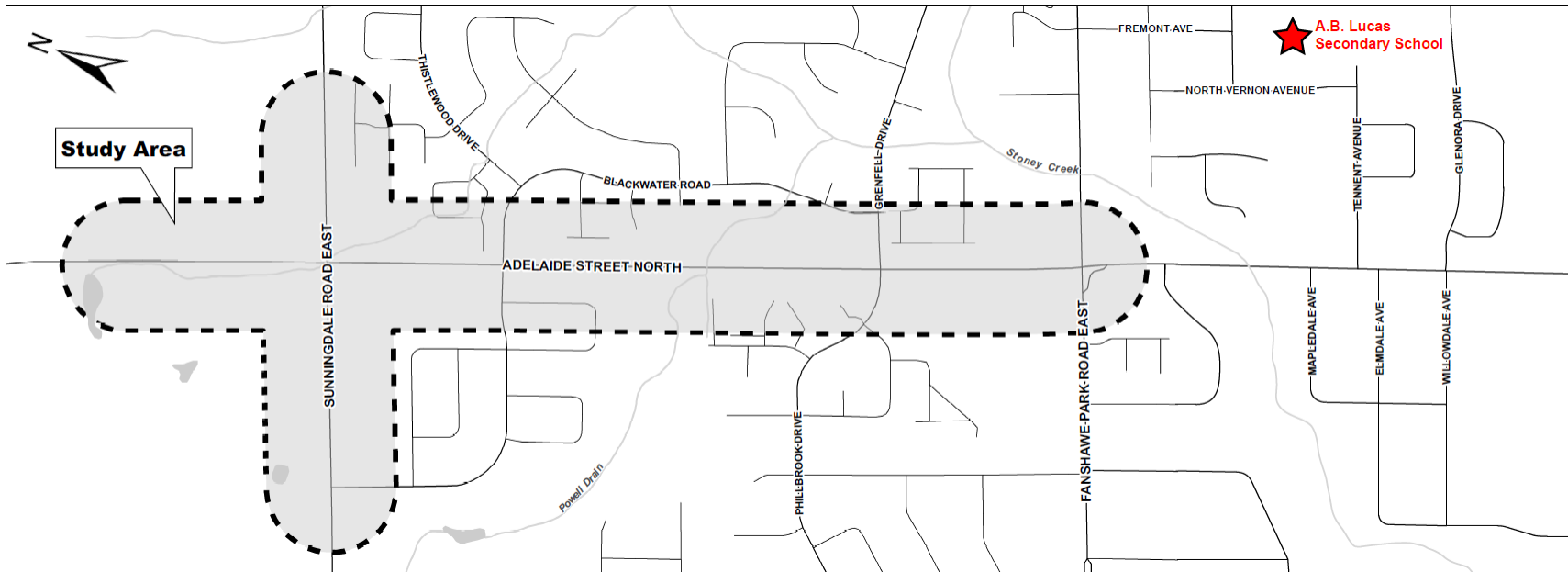

PIC Venue Address

A.B. Lucas Secondary School
Cafeteria
656 Tennent Avenue
London, ON, N5X 1L8

London Transit

LTC Route # - 16
LTC Route # - 40

Driving

If coming from Fanshawe Rd E, turn south onto
Glengarry Ave and west onto Tennent Ave.

If coming from Adelaide Street N, turn east onto
Glenora Dr, north on Glengarry Ave and west
onto Tennent Ave.