

Bill No. 531
2018

By-law No. S.-____-____

A by-law to lay out, constitute, establish and assume lands in the City of London as public highway. (as widening to Western Road, from Essex Street to Platt's Lane)

WHEREAS it is expedient to establish the lands hereinafter described as public highway;

NOW THEREFORE the Municipal Council of The Corporation of the City of London enacts as follows:

1. The lands and premises hereinafter described are laid out, constituted, established and assumed as public highway as widening to Western Road, from Essex Street to Platt's Lane, namely:

"Part of Park Lot 1 North of Wharncliffe Highway, in the geographic Township of London, now in the City of London, designated as Part 8 on Reference Plan 33R-19516. (all of PIN 08078-0187)"

"Part of Park Lot 1 North of Wharncliffe Highway, in the geographic Township of London, now in the City of London, designated as Part 1 on Expropriation Plan ER1112549. (all of PIN 08078-0175)"

"Part of Park Lot 1 North of Wharncliffe Highway, in the geographic Township of London, now in the City of London, designated as Part 1 on Expropriation Plan ER1112550. (all of PIN 08078-0177)"

"Part of Park Lot 1 North of Wharncliffe Highway, in the geographic Township of London, now in the City of London, designated as Part 1 on Expropriation Plan ER1112551. (all of PIN 08078-0179)"

"Part of Park Lot 1 North of Wharncliffe Highway, in the geographic Township of London, now in the City of London, designated as Part 1 on Expropriation Plan ER1112552. (all of PIN 08078-0181)"

"Part of Park Lot 1 North of Wharncliffe Highway, in the geographic Township of London, now in the City of London, designated as Part 1 on Expropriation Plan ER1112553. (all of PIN 08078-0183)"

"Part of Park Lot 1 North of Wharncliffe Highway, in the geographic Township of London, now in the City of London, designated as Parts 14 and 15 on Reference Plan 33R-19516. (all of PIN 08078-0185)"

"Part of Park Lot 1 North of Wharncliffe Highway, in the geographic Township of London, now in the City of London, designated as Part 6 on Reference Plan 33R-11830. (all of PIN 08078-0101)"

"Part of Block "A" on Registered Plan 780 in the City of London, designated as Part 16 on Reference Plan 33R-19516. (all of PIN 08078-0159)"

"Part of Park Lot 3 South of Victoria Street, in the geographic Township of London, now in the City of London, designated as Part 1 on Reference Plan 33R-19655. (all of PIN 08078-0169)"

"Part of Park Lot 3 South of Victoria Street, in the geographic Township of London, now in the City of London, designated as Part 2 on Reference Plan 33R-19655. (all of PIN 08078-0167)"

"Part of Park Lot 3 South of Victoria Street, in the geographic Township of London, now in the City of London, designated as Part 3 on Reference Plan 33R-19655. (all of PIN 08078-0170)"

“Part of Park Lot 2 North of Wharncliffe Highway, in the geographic Township of London, now in the City of London, designated as Part 5 on Reference Plan 33R-19517. (all of PIN 08078-0161)”

“Part of Park Lot 2 North of Wharncliffe Highway, in the geographic Township of London, now in the City of London, designated as Part 6 on Reference Plan 33R-19517. (all of PIN 08078-0163)”

“Part of Park Lot 2 North of Wharncliffe Highway, in the geographic Township of London, now in the City of London, designated as Part 7 on Reference Plan 33R-19517. (all of PIN 08078-0165)”

“Part of Park Lot 2, North of Wharncliffe Highway, in the geographic Township of London, now in the City of London, designated as Part 8 on Reference Plan 33R-19517. (all of PIN 08078-0171)”

“Part of Park Lots 2 and 3 North of Grosvenor Street, in the geographic Township of London, now in the City of London, designated as Part 9 on Reference Plan 33R-19517. (all of PIN 08078-0173)”

“Part of Park Lot 3 North of Grosvenor Street, in the geographic Township of London, now in the City of London, designated as Parts 10 and 11 on Reference Plan 33R-19517. (Part of PIN 08078-0017)”

“Part of Park Lot 3 North of Grosvenor Street, in the geographic Township of London, now in the City of London, designated as Part 12 on Reference Plan 33R-19517. (all of PIN 08078-0152)”

2. This by-law comes into force and effect on the day it is passed.

PASSED in Open Council on August 28, 2018.

Matt Brown
Mayor

Catharine Saunders
City Clerk

First Reading – August 28, 2018
Second Reading – August 28, 2018
Third Reading – August 28, 2018

LOCATION MAP

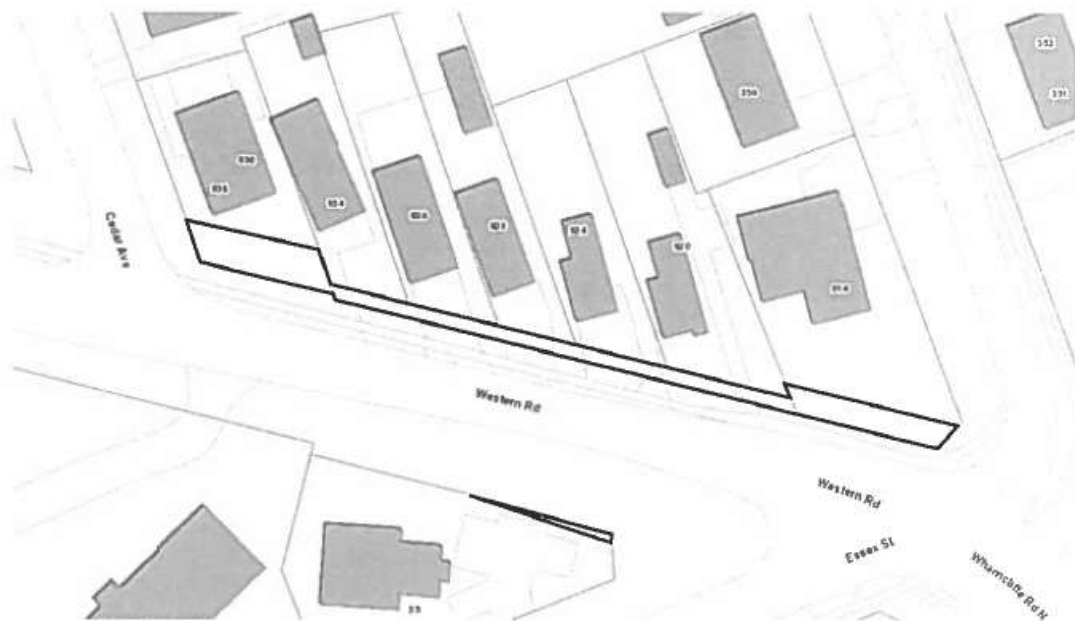

 SUBJECT LANDS