

230 North Centre Road

Official Plan and Zoning By-law
Amendment

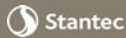

Planning and Environment Committee
July 16, 2018



Site Location



Planning and Environment Committee
July 16, 2018

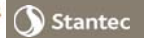

Public Consultation



Initial Proposal

Revised Proposal



Planning and Environment Committee
July 16, 2018

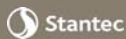

Other Design Changes & Highlights



Initial Proposal

Revised Proposal



Planning and Environment Committee
July 16, 2018

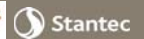

Other Design Changes & Highlights



Initial Proposal

Revised Proposal

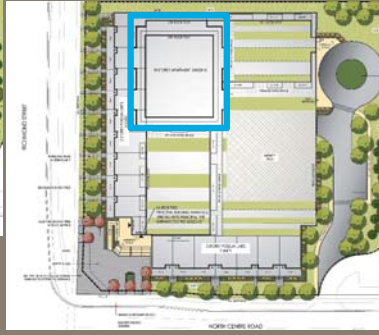

Planning and Environment Committee
July 16, 2018

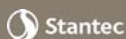

Other Design Changes & Highlights



Initial Proposal

Revised Proposal

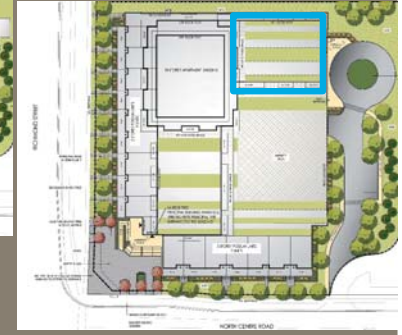

Planning and Environment Committee
July 16, 2018

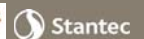

Other Design Changes & Highlights



Initial Proposal

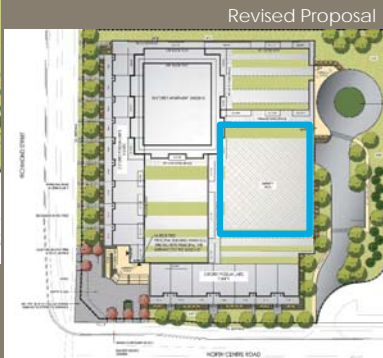

Revised Proposal

Planning and Environment Committee
July 16, 2018



Other Design Changes & Highlights



Initial Proposal



Revised Proposal

Planning and Environment Committee
July 16, 2018



Other Design Changes & Highlights



Initial Proposal



Revised Proposal

Planning and Environment Committee
July 16, 2018



Other Design Changes & Highlights



Planning and Environment Committee
July 16, 2018

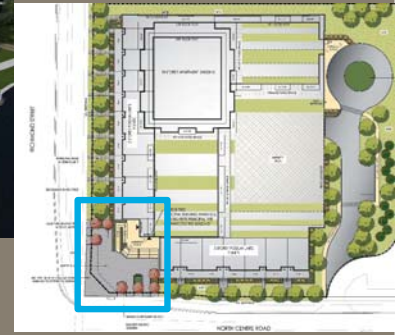

Other Design Changes & Highlights



Planning and Environment Committee
July 16, 2018



Other Design Changes & Highlights



Planning and Environment Committee
July 16, 2018



Other Design Highlights

- Compact development to create density in areas of the City most suitable for it
- Efficient use of existing infrastructure
- Exceptional site and building design
- Substantial underground and enclosed parking
- Sustainable forms of development during construction and long term with building operation
- Significant increase in London's tax base

Planning and Environment Committee
August 28, 2017

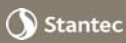

Questions?

