

Bill No. 92  
2018

By-law No. S.- \_\_\_\_\_

A by-law to lay out, constitute, establish and assume lands in the City of London as public highway. (as widening Windermere Court West, east of Ryersie Road)

WHEREAS it is expedient to establish the lands hereinafter described as public highway;

NOW THEREFORE the Municipal Council of The Corporation of the City of London enacts as follows:

1. The lands and premises hereinafter described are laid out, constituted, established and assumed as public highway as widening Windermere Court West, east of Ryersie Road, namely:

“Part of Lots 1 and 2 on Registered Plan 33M-97 in the City of London and County of Middlesex designated as Parts 1 and 2 on Reference Plan 33R-6827.”

2. This by-law comes into force and effect on the day it is passed.

PASSED in Open Council on February 13, 2018.

Matt Brown  
Mayor

Catharine Saunders  
City Clerk

First Reading – February 13, 2018  
Second Reading – February 13, 2018  
Third Reading – February 13, 2018

# LOCATION MAP

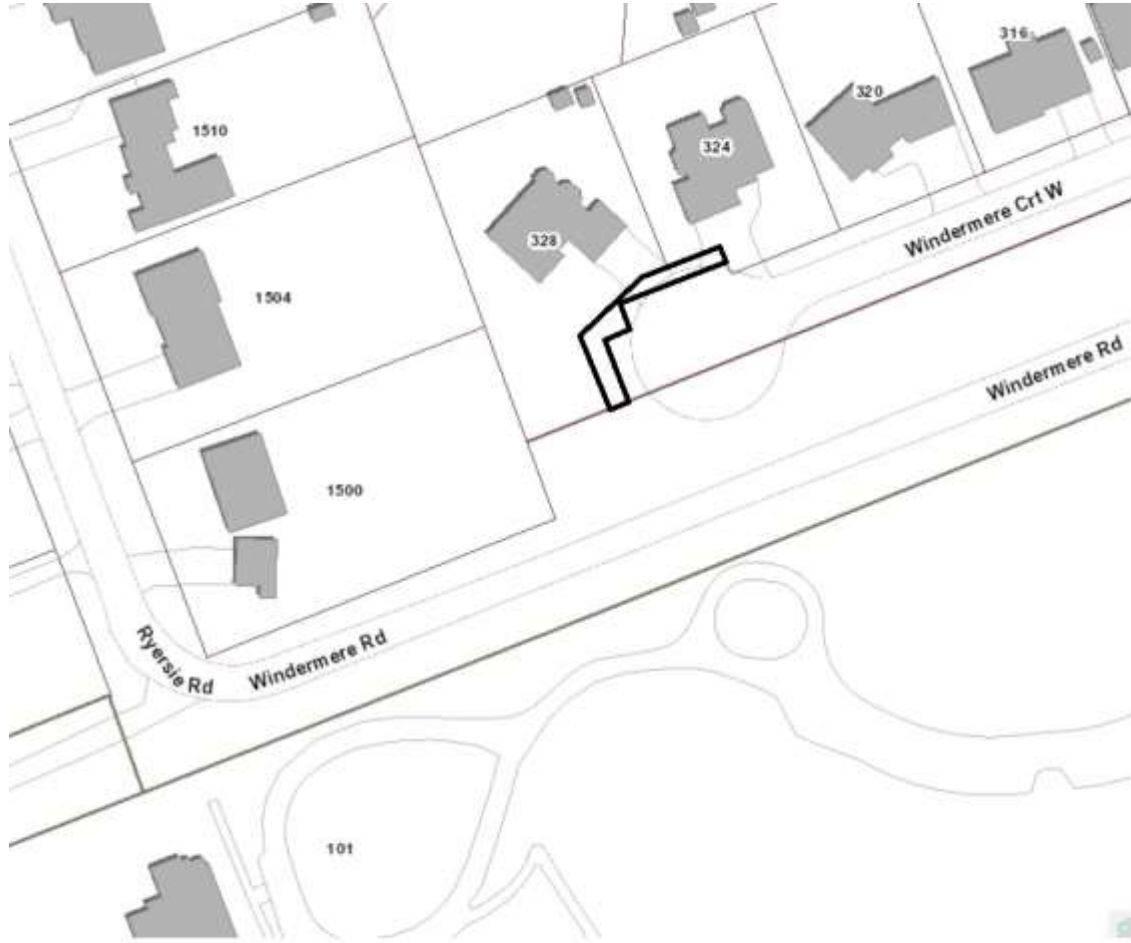

 SUBJECT LANDS