

Bill No. 88  
2018

By-law No. S.- \_\_\_\_\_

A by-law to lay out, constitute, establish and assume lands in the City of London as public highway. (as widening to Base Line Road East, west of Wortley Road)

WHEREAS it is expedient to establish the lands hereinafter described as public highway;

NOW THEREFORE the Municipal Council of The Corporation of the City of London enacts as follows:

1. The lands and premises hereinafter described are laid out, constituted, established and assumed as public highway as widening to Base Line Road East, west of Wortley Road, namely:

“Part of Lot 1, West of Wortley Road, in the City of London, County of Middlesex, designated as Part 1 on Plan 33R-19898.”

2. This by-law comes into force and effect on the day it is passed.

PASSED in Open Council on February 13, 2018.

Matt Brown  
Mayor

Catharine Saunders  
City Clerk

First Reading – February 13, 2018  
Second Reading – February 13, 2018  
Third Reading – February 13, 2018

# LOCATION MAP

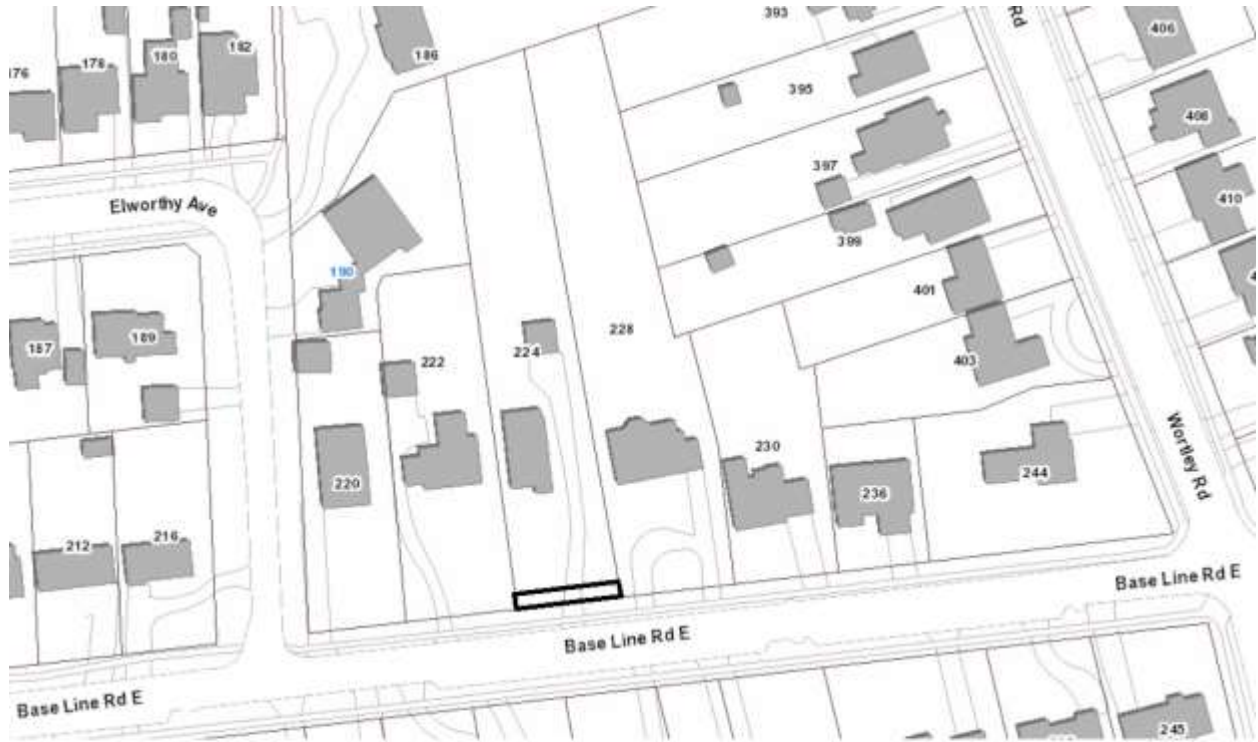

 SUBJECT LANDS