

Bill No. 148
2017

By-law No. S.-_____

A by-law to lay out, constitute, establish and assume lands in the City of London as public highway. (as widening to Riverside Drive, west of Palmtree Avenue)

WHEREAS it is expedient to establish the lands hereinafter described as public highway;

NOW THEREFORE the Municipal Council of The Corporation of the City of London enacts as follows:

1. The lands and premises hereinafter described are laid out, constituted, established and assumed as public highway as widening to Riverside Drive, west of Palmtree Avenue, namely:

“Part of Lot 23, Concession 1, in the geographic Township of London, now in the City of London and County of Middlesex, designated as Parts 6, 7 and 8 on Reference Plan 33R-19682.”

2. This by-law comes into force and effect on the day it is passed.

PASSED in Open Council on April 4, 2017.

Matt Brown
Mayor

Catharine Saunders
City Clerk

First Reading – April 4, 2017
Second Reading – April 4, 2017
Third Reading – April 4, 2017

LOCATION MAP

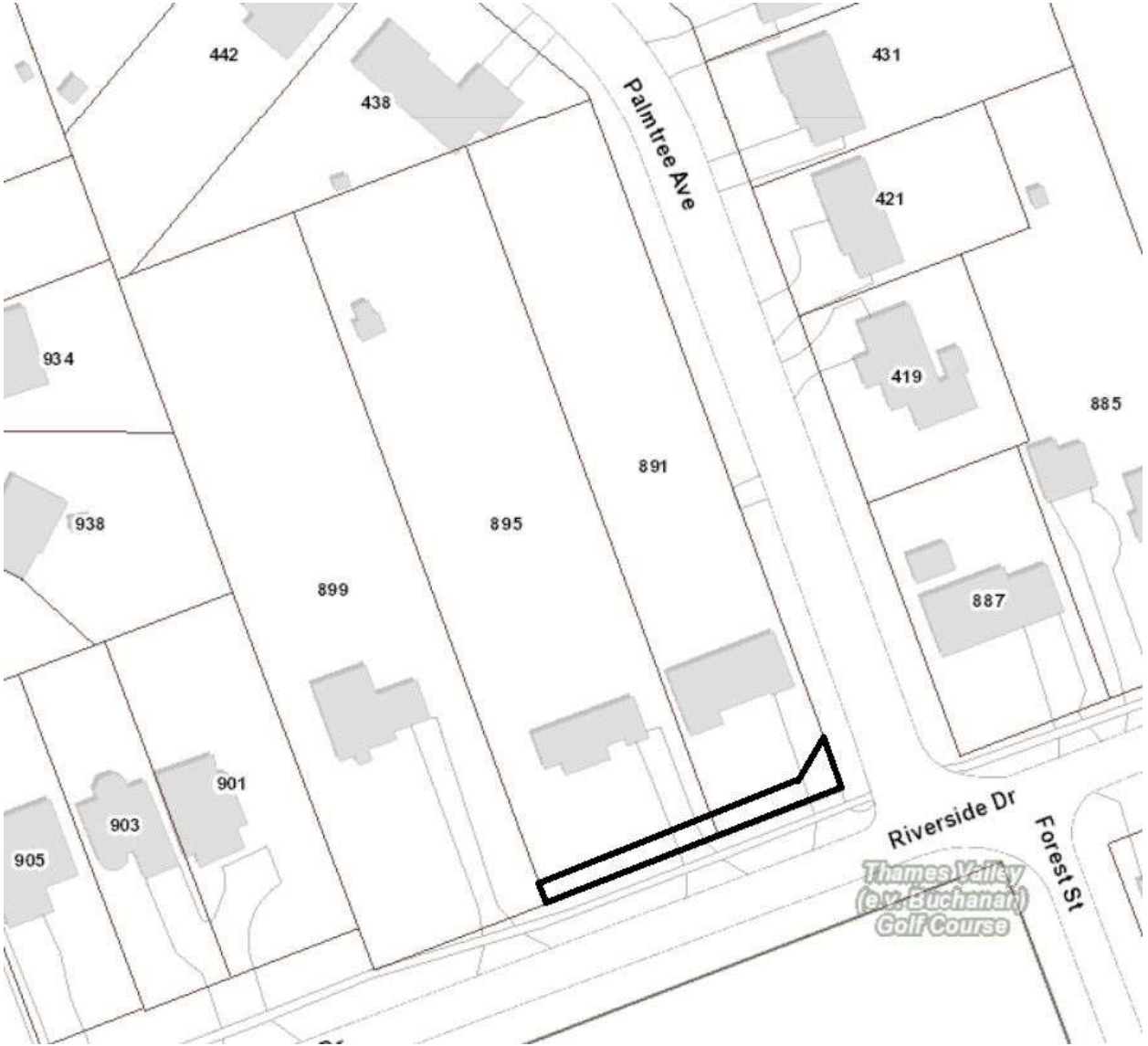

 = SUBJECT LANDS