



P.O. Box 5035
300 Dufferin Avenue
London, ON
N6A 4L9

July 28, 2016

J. Braam
Managing Director, Environmental and Engineering Services and City Engineer

I hereby certify that the Municipal Council, at its meeting held on July 26, 2016 resolved:

14. That, on the recommendation of the Managing Director, Environmental and Engineering Services and City Engineer, the following actions be taken with respect to the Richmond Street Recreational Pathway Crossing Environmental Assessment:

- a) the Environmental Study Report for the Recreational Pathway Crossing of Richmond Street BE ACCEPTED;
- b) a Notice of Completion for the project BE FILED with the Municipal Clerk;
- c) the Environmental Study Report BE PLACED on public record for a 30-day review period; and,
- d) a future funding request BE MADE through the next Multi-Year Budget process to accommodate the construction of this project;

it being noted that the Civic Works Committee received the attached presentation from D. MacRae, Division Manager, Transportation Planning and Design with respect to this matter . (2016-T05) (14/11/CWC)

C. Saunders
City Clerk
\\k

- cc. J. Fleming, Managing Director, Planning and City Planner
E. Soldo, Director, Roads and Transportation
A. MacPherson, Manager, Environmental and Parks Planning
A. Dunbar, Manager, Financial Planning and Policy
D. MacRae, Division Manager, Transportation Planning and Design
J. Fullick, Technologist II
K. Grabowski, Transportation Design Engineer
J. Bruin, Landscape Architect
J. Nethercott, Documentation Services Representative
Chair and Members, Transportation Advisory Committee
Chair and Members, Cycling Advisory Committee
Chair and Members, Environmental and Ecological Planning Advisory Committee
External cc List in the City Clerk's Office



Preferred Alternative

Pathway Alignment (P3)

- less grading impacts based on information received to date
- avoids PSW
- less land required

North Skew (Bridge)

- less impact on potential future development based on information received to date
- lower capital costs (grading)



7



Next Steps

- CWC Meeting (July 18, 2016)
- Council Approval (July 26, 2016)
- 30 Day Public Review (August – September)
- Detailed Design* – to include gateway themed design
- Construction*

* *Dependent on development timing*



10



Preferred Alternative (Basic Concept)

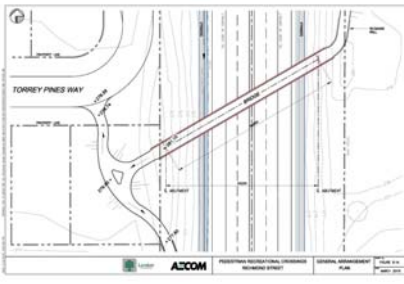

Description of Item	Cost (\$)
Temporary Shoring	\$4,000
Excavation for Foundations	\$8,000
Steel Piles	\$40,000
Concrete in Footings	\$28,000
Concrete in Piers	\$53,000
Concrete in Abutments & Wingwalls	\$68,000
RSS Retaining Walls	\$26,000
Supply, Fabricate & Erect Steel	\$280,000
Concrete Deck	\$143,000
Vertical Bar Handrail	\$69,000
Backfill Abutments	\$10,000
Design Features	\$195,000
Subtotal - Bridge	\$924,000
Approach Works/Grading - Trail	\$330,000
Traffic Management	\$6,000
Ecological Enhancements	\$15,000
Landscaping and Feature Lighting	\$150,000
Engineering Costs	\$250,000
Land Acquisition	\$25,000
Utility Relocations	\$200,000
Contingency	\$200,000
Total	\$1,900,000

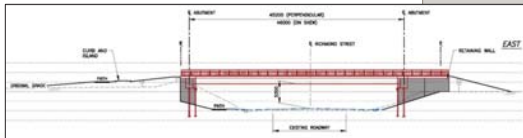

Questions



11



Urban Design

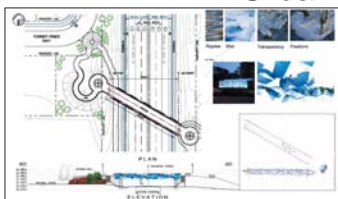

Theme: Thames River Flow Concept

- The structure could be wrapped in multi-coloured translucent panels that represent the flowing river.
- Bridge architecture could be adapted to convey the forest theme.
- Up-lighting could be installed to enhance night time appearance and accentuate the gateway.

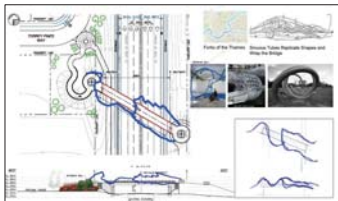

Theme: Forks of the Thames Concept

- A tube could be installed over and around the basic structure to represent the Thames River and its 'forks'.
- Tube could be steel or light weight carbonate material.
- LED lighting could be integrated to illuminate the tube at night.

* *Concepts will be further refined during the Detailed Design phases of this project.*

