

1 201 PARKING LEVEL P1-4 - PHASE 1
SCALE 1:200

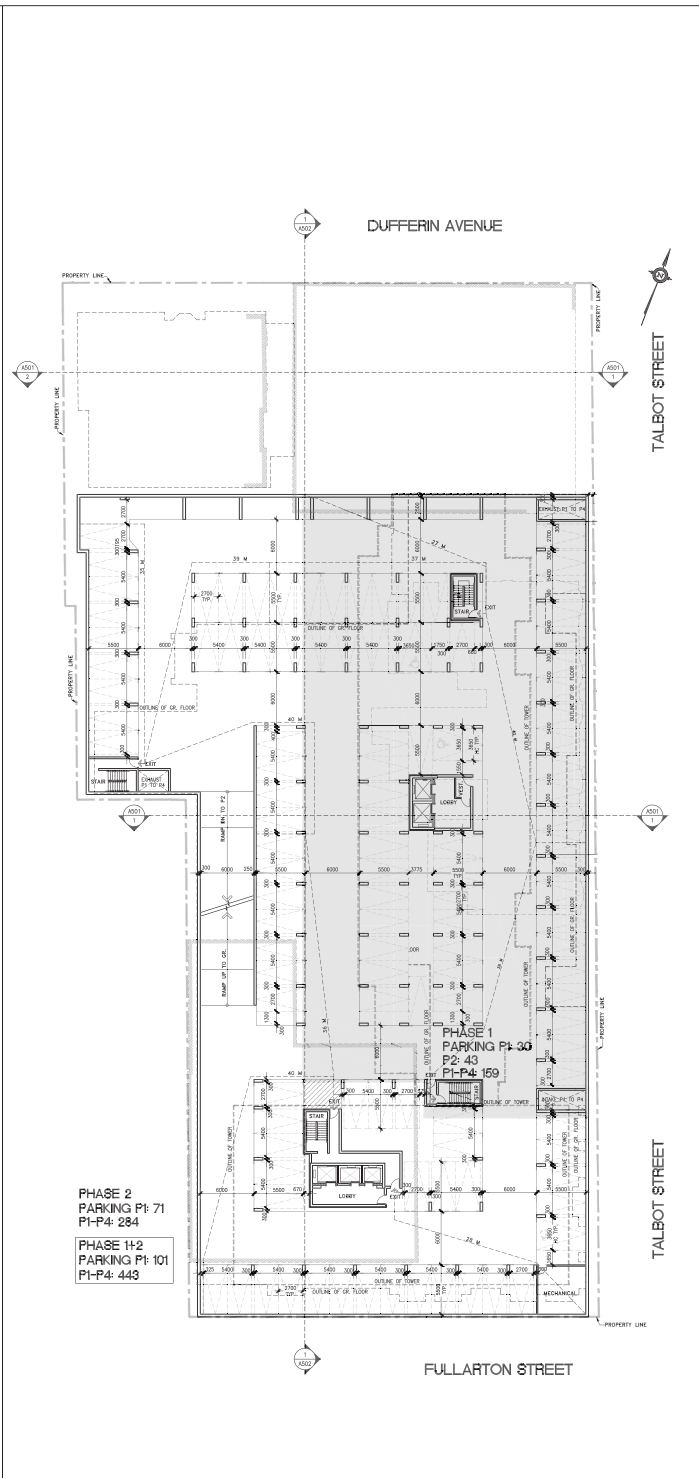

2 201 PARKING LEVEL P1-4 - PHASE 1.2
SCALE 1:200

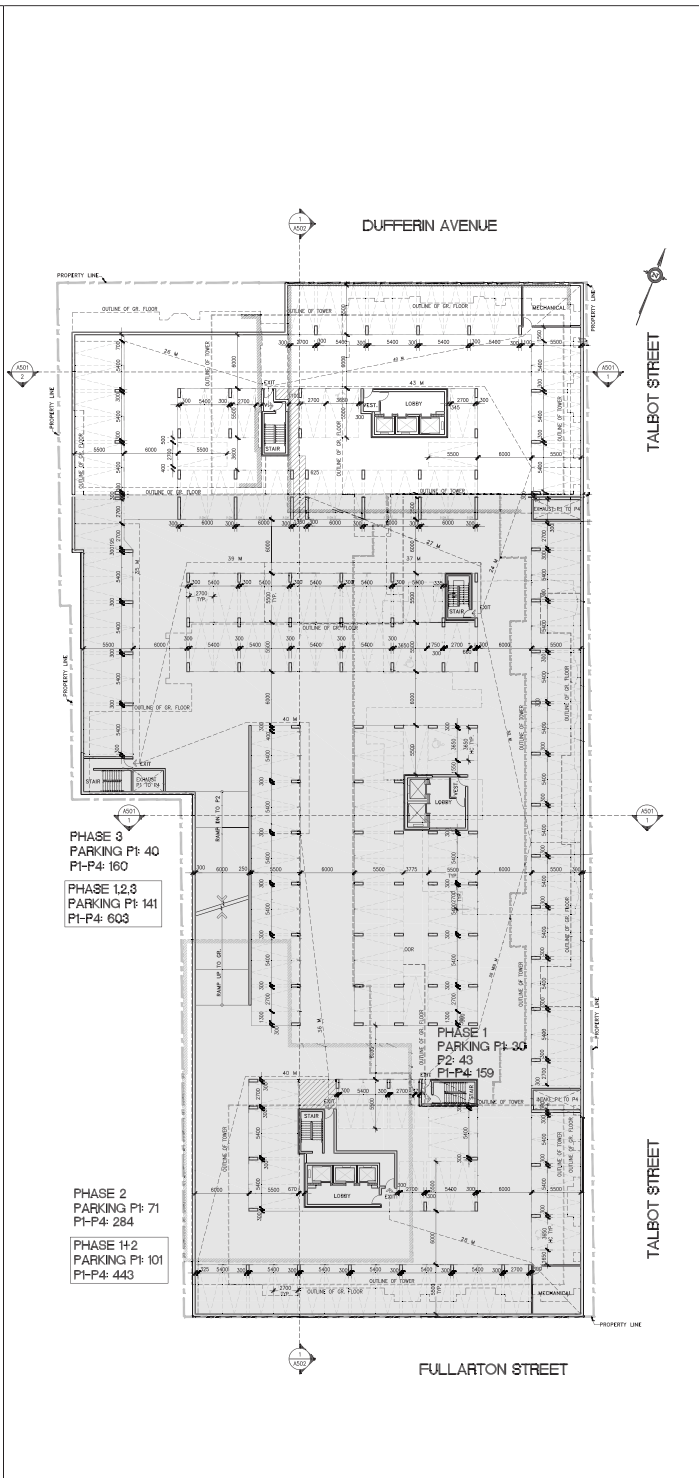

3 201 PARKING LEVEL P1-4 - PHASE 1.2 & 3
SCALE 1:200

GENERAL NOTES

NOT FOR CONSTRUCTION

SHADED AREAS
DEVOTE - PREVIOUSLY BUILT
PHASES

NO.	DATE	REVISIONS	REMARKS

RICHMOND | Architects Ltd.

318 COLLIER STREET
SUITE 1000
TORONTO, ONTARIO M5T 1B5
Tel: (416) 368-3567
Fax: (416) 368-3565
RICHMONDARCH.COM

Client: Proposed Mixed Used Development
Fullerton St. and Talbot St.-City of London

Rygar Corporation Inc.
Tel: (519) 318 8001

Project: UNDERGROUND PARKING P1-4
PHASE 1.2 & 3

Scale: 1:200

Date: 25 JAN 2016
Drawn By: [Name]
Checked By: [Name]

Date: 16 NOV 2015
Scale: 1:200
Revision Number: [Number]

Job No: 2015-004
Sheet: SP A201