



OZ-8624
Planner: Sonia Wise
Telephone: 519-661-2500 extension 5887
Fax: 519-661-5397
Email: soniawise@london.ca
Website: www.london.ca

June 1, 2016

NOTICE OF APPLICATION TO AMEND THE OFFICIAL PLAN & ZONING BY-LAW

The Municipal Council for the City of London is considering an amendment to the City's Official Plan and Zoning By-law Z.-1 for the lands shown on the attached map. The requested change is described below. We are advising you of this application to invite your comments.

APPLICANT:

2431602 Ontario Limited

LOCATION:

420 Fanshawe Park Road East - see attached map

PURPOSE AND EFFECT:

The purpose and effect of the requested Official Plan amendment and Zoning By-law amendment is to permit a mid-rise apartment building with a total of 142 residential units.

POSSIBLE AMENDMENT:

Change Official Plan land use designation from Low Density Residential to Multi-family, Medium Density Residential.

Change Zoning By-law Z.-1 from a Residential R1 (R1-7) Zone which permits single detached dwellings, to a Residential R8 Bonus (R8-4* B_) Zone which permits apartment buildings, handicapped person's apartment buildings, lodging house class 2, stacked townhousing, senior citizen apartment buildings, emergency care establishments, and continuum of care facilities. A bonus zone is requested to permit an increased density of 100u/ha, and a building height of 22.2m in return for enhanced building design, enhanced landscaping, universal accessibility and the provision of underground parking.

HOW TO COMMENT:

Your opinion on this application is important. Please call in, mail, e-mail or fax your comments to The City of London, Planning Services, P.O. Box 5035, London, ON, N6A 4L9, Attention Enter Planners name **by June 30, 2016**, if possible. Please ensure you refer to the file number or municipal address of the item on which you are commenting.

Please Note: Personal information collected and recorded at the Public Participation Meeting, or through written submissions on this subject, is collected under the authority of the Municipal Act, 2001, as amended, and the Planning Act, 1990 R.S.O. 1990, c.P.13 and will be used by Members of Council and City of London staff in their consideration of this matter. The written submissions, including names and contact information and the associated reports arising from

the public participation process, will be made available to the public, including publishing on the City's website. Video recordings of the Public Participation Meeting may also be posted to the City of London's website. Questions about this collection should be referred to Cathy Saunders, City Clerk, 519-661-2500 extension 4937.

This application is considered to be residential intensification under the policies of the City's Official Plan. While a public site plan meeting is not required for this application, site plan matters, including those matters set out in the intensification policies of the Official Plan, will be considered as part of the staff review of this application. By way of this letter, we are also asking for your input and comments regarding this proposal. The matters that you might want to consider include fencing, landscaping, lighting, driveway locations, building scale and design, and the location of the building on the site. These policies are found in Section 3.2.3.5 of the Official Plan, and may be viewed online at the City of London website, www.london.ca

A neighbourhood or community association may exist in your area. If it reflects your views on this proposal, you may wish to select a representative of the association to submit comments on your behalf.

Your representative on City Council, Ward 5 Councillor Maureen Cassidy (office 519-661-2500 extension 4005, e-mail mcassidy@london.ca) would be pleased to discuss any concerns you may have with this application.

PUBLIC MEETING:

The appropriateness of the requested Official Plan and Zoning By-law amendment will be considered at a future meeting of the Planning & Environment Committee. You will receive another notice inviting you to attend this meeting.

If a person or public body does not make oral or written submissions at a public meeting or make written submissions to the City of London before the proposed amendment is adopted, the person or public body may not be entitled to appeal the decision of the Council of the City of London to the Ontario Municipal Board, or may not be added by the Board as a party to the hearing of an appeal unless, in the opinion of the Board, there are reasonable grounds to do so.

FOR MORE INFORMATION:

If you wish to view additional information or material about the requested amendments, it is available to the public for inspection at Planning Services, 206 Dundas St., London, ON, Monday to Friday, 8:30a.m.-4:30p.m.

For more information, please call Sonia Wise at 519-661-2500 extension 5887, referring to "OZ-8624".

TO BE NOTIFIED:



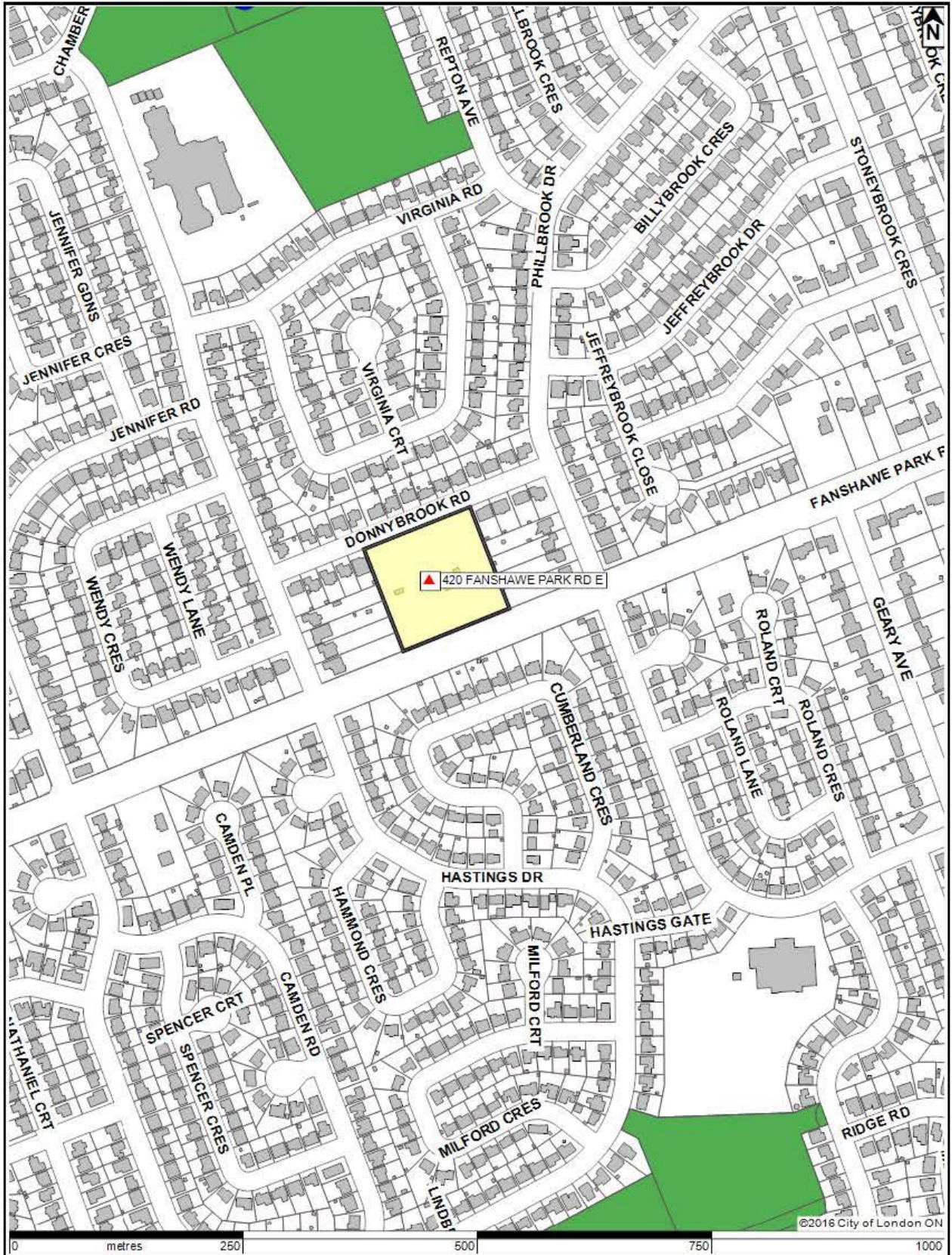

If you wish to be notified of the adoption or refusal of a request to amend the Official Plan and/or Zoning By-law, you must make a written request to the City Clerk, 300 Dufferin Avenue, P.O. Box 5035, London, ON N6A 4L9. You will also be notified if you address the Planning & Environment Committee at the public meeting about this application and leave your name and address with the Secretary of the Committee.



LOCATION MAP

File Number: OZ-8624
 Created By: **Sonia Wise**
 Date: **2016-05-20**
 Scale: **1:5000**

LEGEND

-  Subject Site
-  Parks
-  Assessment Parcels
-  Buildings
-  Address Numbers



Corporation of the City of London
 Prepared By: Planning and Development

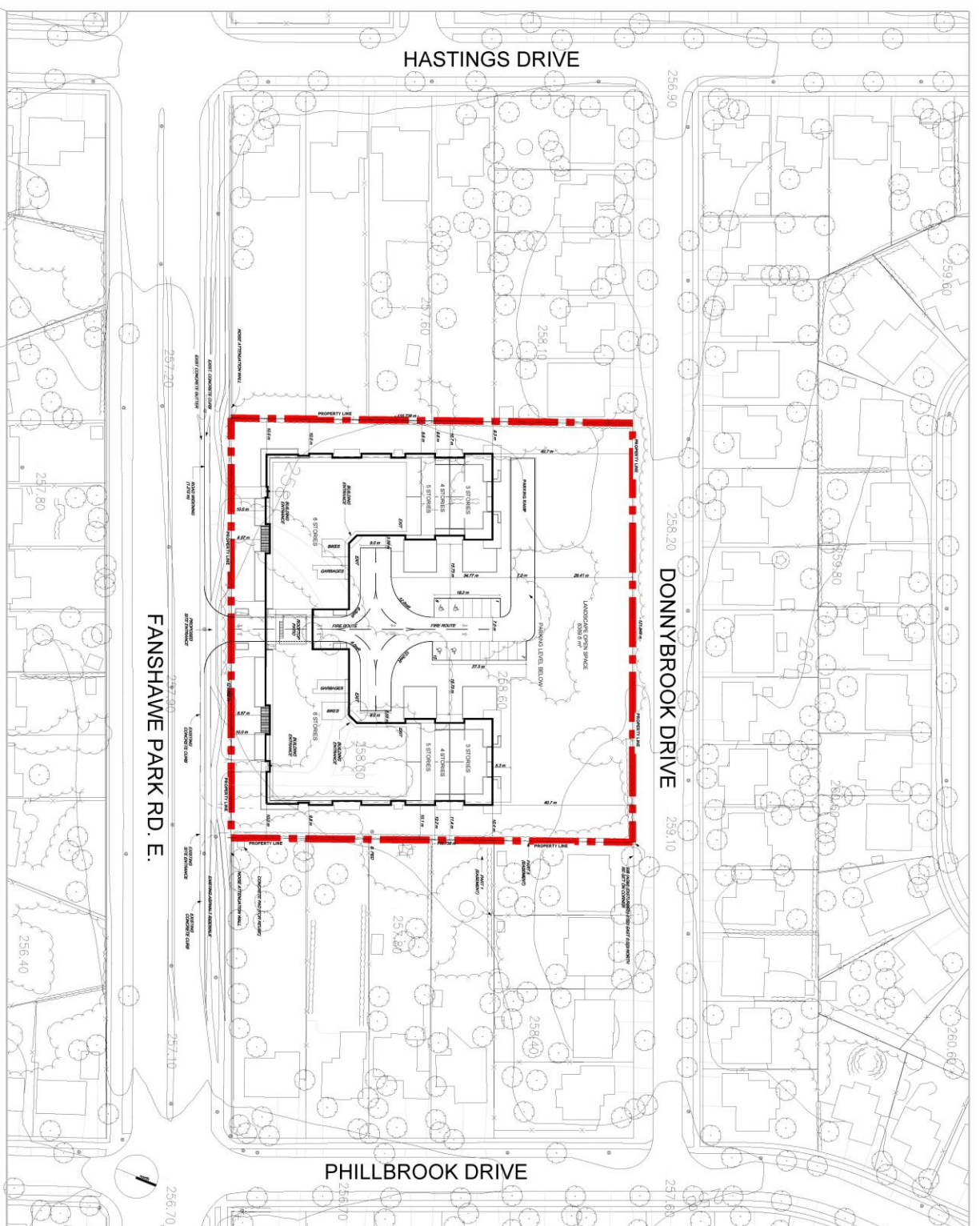

Legal Description
 LOTS 10, 11, 12, 13, 14, 15, 16, 17, 18, 19, 20, 21, 22, 23, 24, 25, 26, 27, 28, 29, 30, 31, 32, 33, 34, 35, 36, 37, 38, 39, 40, 41, 42, 43, 44, 45, 46, 47, 48, 49, 50, 51, 52, 53, 54, 55, 56, 57, 58, 59, 60, 61, 62, 63, 64, 65, 66, 67, 68, 69, 70, 71, 72, 73, 74, 75, 76, 77, 78, 79, 80, 81, 82, 83, 84, 85, 86, 87, 88, 89, 90, 91, 92, 93, 94, 95, 96, 97, 98, 99, 100, 101, 102, 103, 104, 105, 106, 107, 108, 109, 110, 111, 112, 113, 114, 115, 116, 117, 118, 119, 120, 121, 122, 123, 124, 125, 126, 127, 128, 129, 130, 131, 132, 133, 134, 135, 136, 137, 138, 139, 140, 141, 142, 143, 144, 145, 146, 147, 148, 149, 150, 151, 152, 153, 154, 155, 156, 157, 158, 159, 160, 161, 162, 163, 164, 165, 166, 167, 168, 169, 170, 171, 172, 173, 174, 175, 176, 177, 178, 179, 180, 181, 182, 183, 184, 185, 186, 187, 188, 189, 190, 191, 192, 193, 194, 195, 196, 197, 198, 199, 200, 201, 202, 203, 204, 205, 206, 207, 208, 209, 210, 211, 212, 213, 214, 215, 216, 217, 218, 219, 220, 221, 222, 223, 224, 225, 226, 227, 228, 229, 230, 231, 232, 233, 234, 235, 236, 237, 238, 239, 240, 241, 242, 243, 244, 245, 246, 247, 248, 249, 250, 251, 252, 253, 254, 255, 256, 257, 258, 259, 260, 261, 262, 263, 264, 265, 266, 267, 268, 269, 270, 271, 272, 273, 274, 275, 276, 277, 278, 279, 280, 281, 282, 283, 284, 285, 286, 287, 288, 289, 290, 291, 292, 293, 294, 295, 296, 297, 298, 299, 300, 301, 302, 303, 304, 305, 306, 307, 308, 309, 310, 311, 312, 313, 314, 315, 316, 317, 318, 319, 320, 321, 322, 323, 324, 325, 326, 327, 328, 329, 330, 331, 332, 333, 334, 335, 336, 337, 338, 339, 340, 341, 342, 343, 344, 345, 346, 347, 348, 349, 350, 351, 352, 353, 354, 355, 356, 357, 358, 359, 360, 361, 362, 363, 364, 365, 366, 367, 368, 369, 370, 371, 372, 373, 374, 375, 376, 377, 378, 379, 380, 381, 382, 383, 384, 385, 386, 387, 388, 389, 390, 391, 392, 393, 394, 395, 396, 397, 398, 399, 400, 401, 402, 403, 404, 405, 406, 407, 408, 409, 410, 411, 412, 413, 414, 415, 416, 417, 418, 419, 420, 421, 422, 423, 424, 425, 426, 427, 428, 429, 430, 431, 432, 433, 434, 435, 436, 437, 438, 439, 440, 441, 442, 443, 444, 445, 446, 447, 448, 449, 450, 451, 452, 453, 454, 455, 456, 457, 458, 459, 460, 461, 462, 463, 464, 465, 466, 467, 468, 469, 470, 471, 472, 473, 474, 475, 476, 477, 478, 479, 480, 481, 482, 483, 484, 485, 486, 487, 488, 489, 490, 491, 492, 493, 494, 495, 496, 497, 498, 499, 500, 501, 502, 503, 504, 505, 506, 507, 508, 509, 510, 511, 512, 513, 514, 515, 516, 517, 518, 519, 520, 521, 522, 523, 524, 525, 526, 527, 528, 529, 530, 531, 532, 533, 534, 535, 536, 537, 538, 539, 540, 541, 542, 543, 544, 545, 546, 547, 548, 549, 550, 551, 552, 553, 554, 555, 556, 557, 558, 559, 560, 561, 562, 563, 564, 565, 566, 567, 568, 569, 570, 571, 572, 573, 574, 575, 576, 577, 578, 579, 580, 581, 582, 583, 584, 585, 586, 587, 588, 589, 590, 591, 592, 593, 594, 595, 596, 597, 598, 599, 600, 601, 602, 603, 604, 605, 606, 607, 608, 609, 610, 611, 612, 613, 614, 615, 616, 617, 618, 619, 620, 621, 622, 623, 624, 625, 626, 627, 628, 629, 630, 631, 632, 633, 634, 635, 636, 637, 638, 639, 640, 641, 642, 643, 644, 645, 646, 647, 648, 649, 650, 651, 652, 653, 654, 655, 656, 657, 658, 659, 660, 661, 662, 663, 664, 665, 666, 667, 668, 669, 670, 671, 672, 673, 674, 675, 676, 677, 678, 679, 680, 681, 682, 683, 684, 685, 686, 687, 688, 689, 690, 691, 692, 693, 694, 695, 696, 697, 698, 699, 700, 701, 702, 703, 704, 705, 706, 707, 708, 709, 710, 711, 712, 713, 714, 715, 716, 717, 718, 719, 720, 721, 722, 723, 724, 725, 726, 727, 728, 729, 730, 731, 732, 733, 734, 735, 736, 737, 738, 739, 740, 741, 742, 743, 744, 745, 746, 747, 748, 749, 750, 751, 752, 753, 754, 755, 756, 757, 758, 759, 760, 761, 762, 763, 764, 765, 766, 767, 768, 769, 770, 771, 772, 773, 774, 775, 776, 777, 778, 779, 780, 781, 782, 783, 784, 785, 786, 787, 788, 789, 790, 791, 792, 793, 794, 795, 796, 797, 798, 799, 800, 801, 802, 803, 804, 805, 806, 807, 808, 809, 810, 811, 812, 813, 814, 815, 816, 817, 818, 819, 820, 821, 822, 823, 824, 825, 826, 827, 828, 829, 830, 831, 832, 833, 834, 835, 836, 837, 838, 839, 840, 841, 842, 843, 844, 845, 846, 847, 848, 849, 850, 851, 852, 853, 854, 855, 856, 857, 858, 859, 860, 861, 862, 863, 864, 865, 866, 867, 868, 869, 870, 871, 872, 873, 874, 875, 876, 877, 878, 879, 880, 881, 882, 883, 884, 885, 886, 887, 888, 889, 890, 891, 892, 893, 894, 895, 896, 897, 898, 899, 900, 901, 902, 903, 904, 905, 906, 907, 908, 909, 910, 911, 912, 913, 914, 915, 916, 917, 918, 919, 920, 921, 922, 923, 924, 925, 926, 927, 928, 929, 930, 931, 932, 933, 934, 935, 936, 937, 938, 939, 940, 941, 942, 943, 944, 945, 946, 947, 948, 949, 950, 951, 952, 953, 954, 955, 956, 957, 958, 959, 960, 961, 962, 963, 964, 965, 966, 967, 968, 969, 970, 971, 972, 973, 974, 975, 976, 977, 978, 979, 980, 981, 982, 983, 984, 985, 986, 987, 988, 989, 990, 991, 992, 993, 994, 995, 996, 997, 998, 999, 1000.

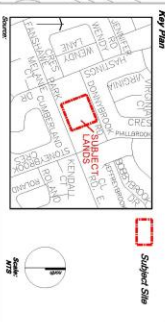

Site Statistics

Zone/Analysis	Residential - RM4
Proposed	Residential - RM4
Residential Type	Residential - RM4
Lot Area	1,000 m ²
Lot Footprint	1,000 m ²
Front Yard	4.2 m
Side Yard	4.2 m
Rear Yard	4.2 m
Building Height (max)	15.0 m
Open Space Planting	150 m ²

Residential - RM4	Proposed
Residential Type	Residential - RM4
Lot Area	1,000 m ²
Lot Footprint	1,000 m ²
Front Yard	4.2 m
Side Yard	4.2 m
Rear Yard	4.2 m
Building Height (max)	15.0 m
Open Space Planting	150 m ²
Landscaped Open Land Coverage	30%
Building Height (max)	15.0 m
Open Space Planting	150 m ²

PLANNING URBAN DESIGN & LANDSCAPE ARCHITECTURE

MHBC ARCHITECTURE

3000 EASTERN AVENUE, SUITE 200, LONDON, ONTARIO N6A 2P1 | TEL: 519-863-1111 | WWW.MHBCA.COM

Project: 420 Fanshawe Park Rd. E.
 Date: December 02, 2019
 Drawn by: LJM
 Plan Number: 15081 (A/C/B)
 File No.: 1219844

SITE PLAN

Plan No. 1 OF 1

Project: 420 Fanshawe Park Rd. E.
 Plan No.: 1219844

420 Fanshawe Park Road East
Conceptual Rendering

