

Bill No. 18  
2016

By-law No. Z.-1-16\_\_\_\_\_

A by-law to amend By-law No. Z.-1 to rezone an area of land located at 1155-1236 Gough Road and 1974-2119 Gough Avenue

WHEREAS **Sifton Properties Limited** has applied to rezone an area of land located at 1155-1236 Gough Road and 1974-2119 Gough Avenue, as shown on the map attached to this by-law, as set out below;

NOW THEREFORE the Municipal Council of The Corporation of the City of London enacts as follows:

1. Schedule "A" to By-law No. Z.-1 is amended by changing the zoning applicable to lands located at 1155-1236 Gough Road and 1974-2119 Gough Avenue, as shown on the attached map comprising part of Key Map No. A103, **from** a Residential R1 Special Provision (R1-3(7)) Zone **to** a Residential R1 Special Provision (R1-3(\_)) Zone.

2. Section Number 5.4 of the Residential Zone (R1) Zone is amended by adding the following Special Provision:

R1-3(_)	1155-1236 Gough Road and 1974-2119 Gough Avenue		
a)	Regulation		
i)	Interior Side Yard Depth (Minimum)	1.2 metres (3.94 feet)	to the property line
ii)	Lot Frontage (Minimum)	11 metres (36.09 feet)	
iii)	Lot coverage for a One-storey single detached dwelling (Maximum)	50%	

3. The inclusion in this By-law of imperial measure along with metric measure is for the purpose of convenience only and the metric measure governs in case of any discrepancy between the two measures.

4. This By-law shall come into force and be deemed to come into force in accordance with Section 34 of the *Planning Act, R.S.O. 1990, c. P13*, either upon the date of the passage of this by-law or as otherwise provided by the said section.

PASSED in Open Council on December 8<sup>th</sup>, 2015.

Matt Brown  
Mayor

Catharine Saunders  
City Clerk

First Reading - December 8, 2015  
Second Reading – December 8, 2015  
Third Reading - December 8, 2015

AMENDMENT TO SCHEDULE "A" (BY-LAW NO. Z-1)

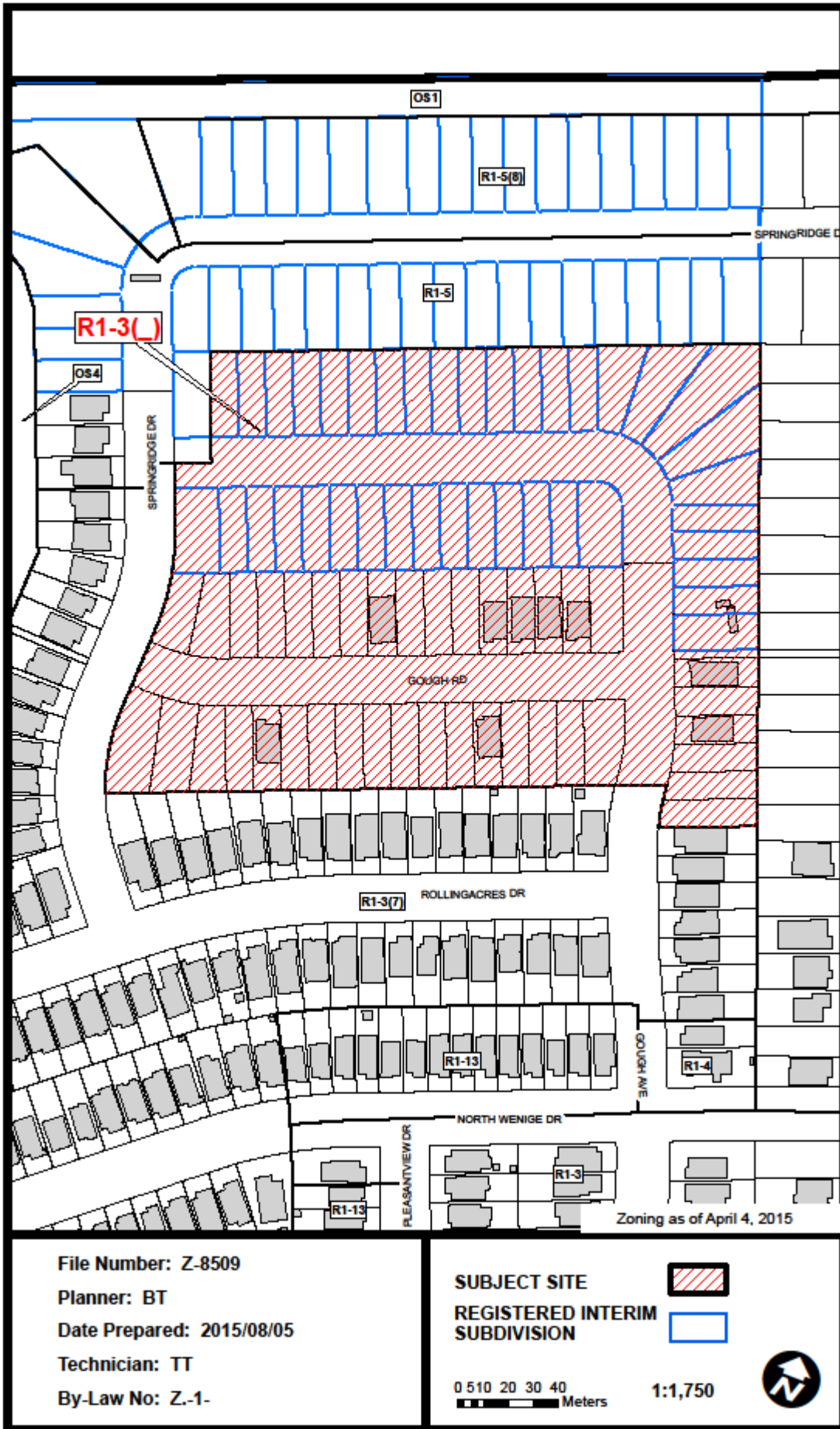

File Number: Z-8509  
 Planner: BT  
 Date Prepared: 2015/08/05  
 Technician: TT  
 By-Law No: Z.-1-

**SUBJECT SITE**   
**REGISTERED INTERIM SUBDIVISION** 

0 5 10 20 30 40  
 Meters

1:1,750



Zoning as of April 4, 2015

Geodatabase