



Social Innovation Shared Space





201 King Street



London Life Solutions Lab



Impact Junk



London Training Centre

Social Enterprise Lab

The image is a composite graphic for a 'Social Enterprise Lab'. It features two photographs. The top photograph shows two men wearing black t-shirts with the word 'impact' in green. They are standing in front of a white van that also has 'impact' branding. To the right of this photo is a yellow rounded rectangle containing the text 'Impact Junk'. The bottom photograph shows a kitchen scene with several people, including one man in a white apron and another in a red cap, working at a counter. To the right of this photo is an orange rounded rectangle containing the text 'London Training Centre'. At the bottom of the entire graphic is a blue horizontal bar with the text 'Social Enterprise Lab' in white. A vertical green bar is on the right side of the graphic, and a thin orange vertical bar is between the yellow and orange rectangles.



VERGE COMMUNITY CAPITAL COLLECTIVE

VERGE connects local caring investors with local enterprises that have a social or environmental mission at their core.



SOCIAL INVESTORS



SOCIAL ENTERPRISES & SOCIAL ENTREPRENEURS

Social Finance Lab

\$1 million inflow to our city + \$500,000 funding from London sources

Canada

Ontario

Ursuline Sisters

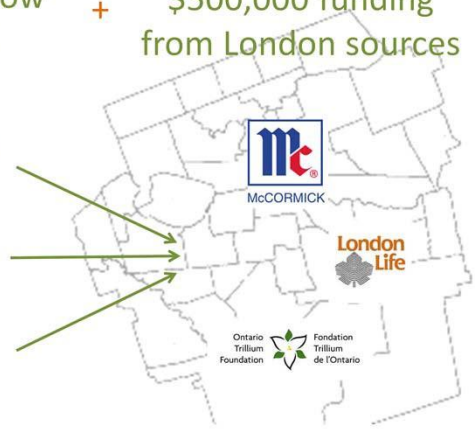

We HAVE grants = \$1.5M

\$500,000
investment into
our city

+

\$3 million from
London sources



Chris & Lina Bowden

We HAVE loans = \$3.5M

- \$289,000 Accessibility Improvements
- \$ 50,000 Start-Up Costs
- \$600,00 Renovations
- \$550,00 Furniture, Equipment & Lease Up

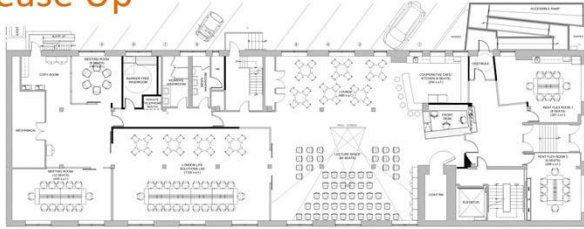

We NEED an additional \$1.5M

Strengthening
our Community

- 300 users
- 50 new start-ups

Building
A Sustainable City

- 50-100 new jobs
- 100 efficient nonprofits

Growing
our Economy

- 150+ organizations collaborating

Leading
in Public Service

- 3 sectors (public, private, nonprofit) working together

We WILL help London succeed

Advanced Studies in Arts & Humanities, Western University
 Big Game Road Trips
 Brain Injury Association of London & Region
 Connect for Mental Health
 Daya Counselling Centre
 Emerging Leaders
 Fanshawe College
 Glen Farms Herbs & Preserves
 Goodwill Industries, Ontario Great Lakes
 Growing Chefs

Horizon Leadership Institute
 Johnny Fansher & Ten Star Financial (SRI)
 Kovacs Group Inc.
 London Arts Council
 London Fringe Theatre Festival
 London Heritage Council
 London LINK Magazine
 London Youth Advisory Council
 McLeod Network Media
 Mindyourmind
 Mischievous Cat Productions

Neighbourhood Watch
 Pillar Nonprofit Network
 Redtape Legal Services Professional Corporation
 Research Centre for Health Equity & Social Inclusion
 rtraction
 Southwestern Ontario Angel Group
 Techalliance of Southwestern Ontario
 The Social Beehive
 UnLondon
 VERGE Community Capital Collective



Tenants

Joni Baechler
Lina Bowden
Michelle Boyer
Adam Caplan
Justin Carter
Paul H. Cocker
David Corke
Kevin Cougler
Al Day
Charlene Doak-Gebauer
Dan Douglas
Kathryn Eggert
Laura Elliott
Johnny Fansher
Cara Finn
Keith Gibbons
David Glen

James M. Good
Tania Goodine
Andrea Halwa
Zul Karmali & Nashila
Dharshi
Tim Kingsmill
Gus Kotsiomitris
John A. LaPorta
Larry Lau
Marlene Janzen Le Ber
Andrew Lockie
Janette MacDonald
Sister Theresa Mahoney
Andrea McNaughton
Chris Moss
Abe Oudshoorn
David Patchell-Evans
Greg Plavford

John Pollock
Simon Pont
Martha Powell
Sean Quigley
Michelle Quintyn
Sister Margo Ritchie
Trae Robinson
Noel Rondinelli
McMichael Ruth
Robert G. Siskind
Paulette Soscia
Jens Stickling
Tonya Surman
Kadie Ward
Assaf Weisz
Kate Wiggins
Jill Wilcox



Centre for Research on Community Testimonials Health Equity & Social Inclusion

Innovation



**Help us Achieve
Our Vision for London**