

ADVANCED MANUFACTURING PARK

**A PRESENTATION TO LONDON CITY COUNCIL
JUNE 2014**

+ AGENDA

- DISCOVERY PARK/STILLER CENTRE UPDATE
- ADVANCED MANUFACTURING PARK UPDATE
- FUTURE PLANS
- NEXT STEPS

+ WESTERN RESEARCH PARKS

INTEGRATED - ALIGNED - ENABLING



Sarnia-Lambton

Bio-Industrial
Chemical
Energy
Environment



Discovery Park

Life Sciences
IT
Imaging
Analytics



Advanced Manufacturing Park

Materials
Wind
Environment
Power

Effectively links Western's Research Strengths with Industry and the Region

+ DISCOVERY PARK/STILLER

- 98-PERCENT OCCUPANCY
- 70 TENANTS, 600 EMPLOYEES
- \$40 MILLION ANNUAL ECONOMIC CONTRIBUTION
- RETURN REINVESTED IN ENTREPRENEURSHIP
- NOW RANKED AMONG TOP 25 PARKS WORLDWIDE*
- NEW MEDICAL INNOVATION NETWORK EXPANSION PLAN AT STILLER UNDERWAY
- STILLER SUBSIDY ENDING IN 2016

* UBI INDEX – ZURICH, SWITZERLAND



+ ADVANCED MANUFACTURING PARK

- FRAUNHOFER PROJECT CENTRE OPERATIONAL
 - 18 CONTRACTS, \$1.7 MILLION VALUE
- WINDEEE DOME INITIATING START UP PHASE
- PARK'S NEWEST ADDITION "THE COLLIDER" OPENED TODAY



+ **ADVANCED MANUFACTURING PARK**

THE COLLIDER

- **UNIQUE, EDGY, ENERGETIC**
- **CONSISTENT WITH THE CONCEPT OF TWO INDEPENDENT ENTITIES COMING TOGETHER TO CREATE SOMETHING BIGGER AND BETTER**
- **REFLECTIVE OF THE COLLABORATIONS (“COLLISIONS”) THAT WE HOPE TO CREATE BETWEEN RESEARCH AND INDUSTRY**



+ ADVANCED MANUFACTURING PARK

THE COLLIDER

- WELCOME CENTRE
- RD&C HUB
- ENTRY POINT FOR INDUSTRY
- 28K SF OFFICE, MEETING, TESTING, TEAM ROOMS
- SECURED 1st TWO TENANTS THIS MONTH

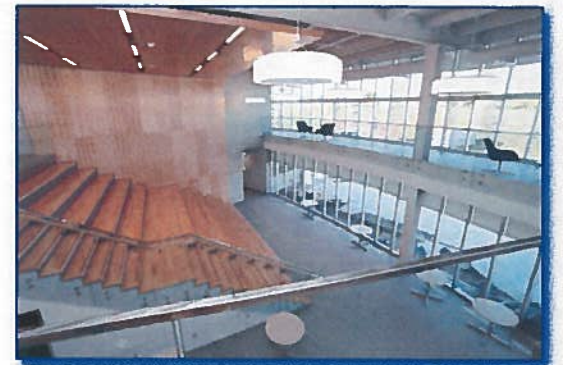



AMP MASTER PLAN

ORIGINAL SITE CONFIGURATION

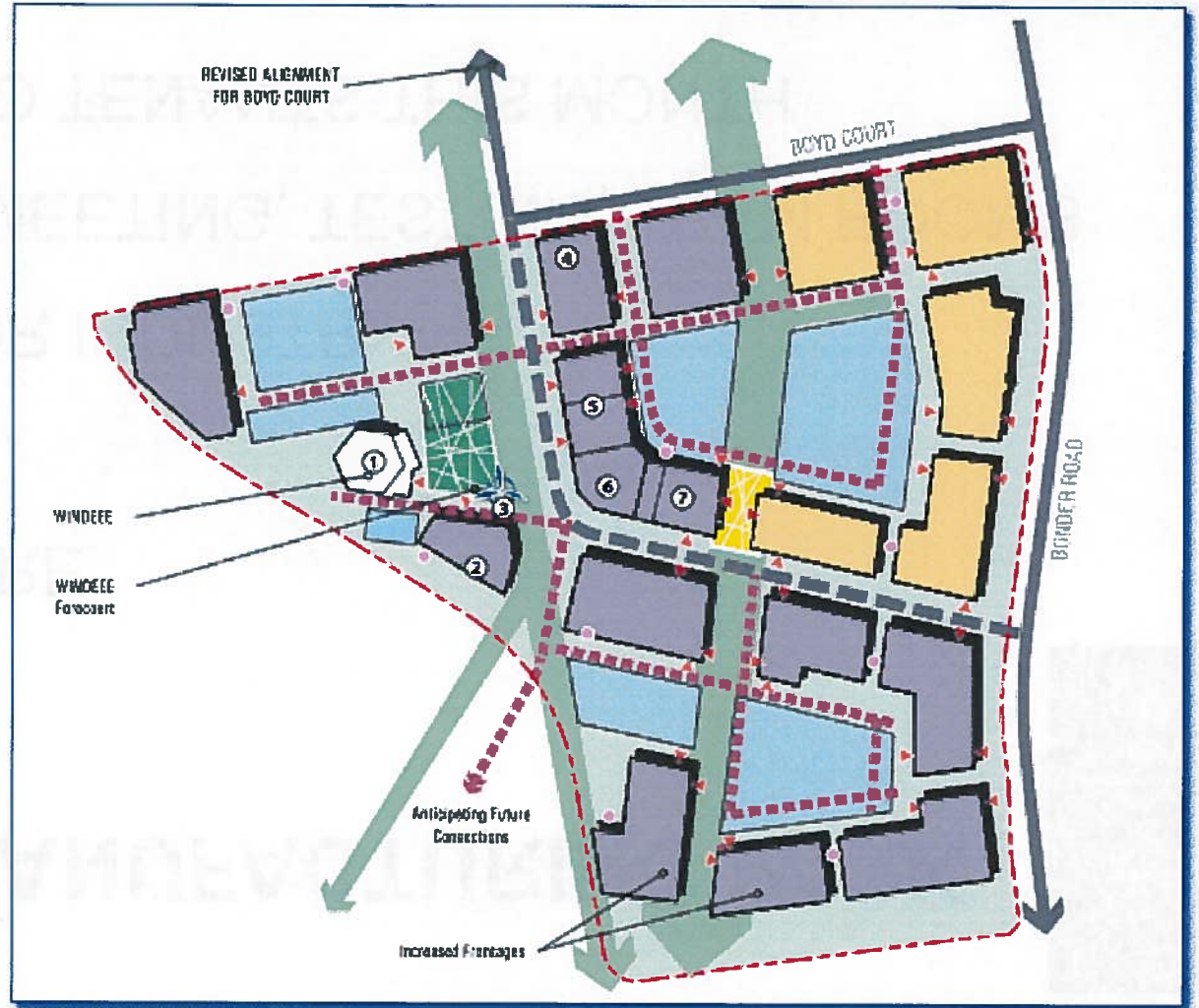

+ AMP MASTER PLAN

EXISTING LAND ALLOCATION

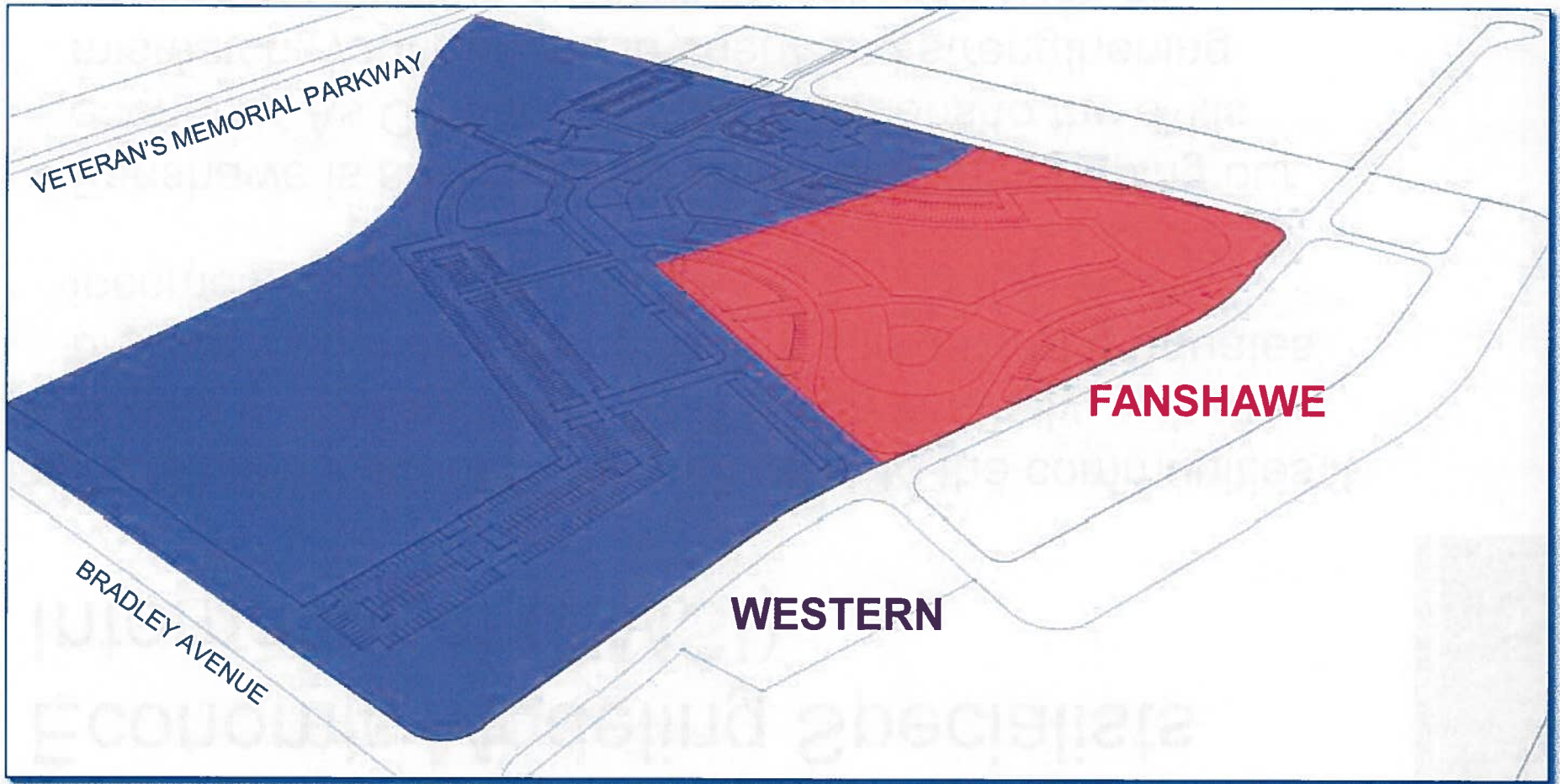

+ Economic Modeling Specialists International (EMSI)

- Fanshawe's economic contribution to the communities it serves is approximately \$1.6 billion annually, with the biggest influence coming from the impact of graduates' incomes, adding close to \$1.4 billion to the region.
- Fanshawe is an economic driver that is reshaping our economy. As Ontario looks for solutions to the skills mismatch, youth unemployment and strengthening applied research in curriculum, colleges such as Fanshawe are well positioned to deliver high-quality, high-return programs that will serve labour market needs.

+ Strategic Mandate Agreement – 2014 - 2017

- Fanshawe has developed a Research and Innovation Strategy that will embed research and innovation into the curriculum of all postsecondary programs within the next five years.
- Fanshawe has set a goal of being among the top colleges in this area by increasing research and innovation activities over the next decade.
- Working collaboratively with community partners and educational institutions, like Western, the city and LEDC to promote economic growth, prosperity and innovation.



**Proposal to:
FedDev Ontario
Investing in
Commercialization
Partnerships
Program**

APRIL 30, 2014



**CANADIAN
CENTRE FOR
PRODUCT
VALIDATION**

+ AMP MASTER PLAN

EXISTING PARK FACILITIES

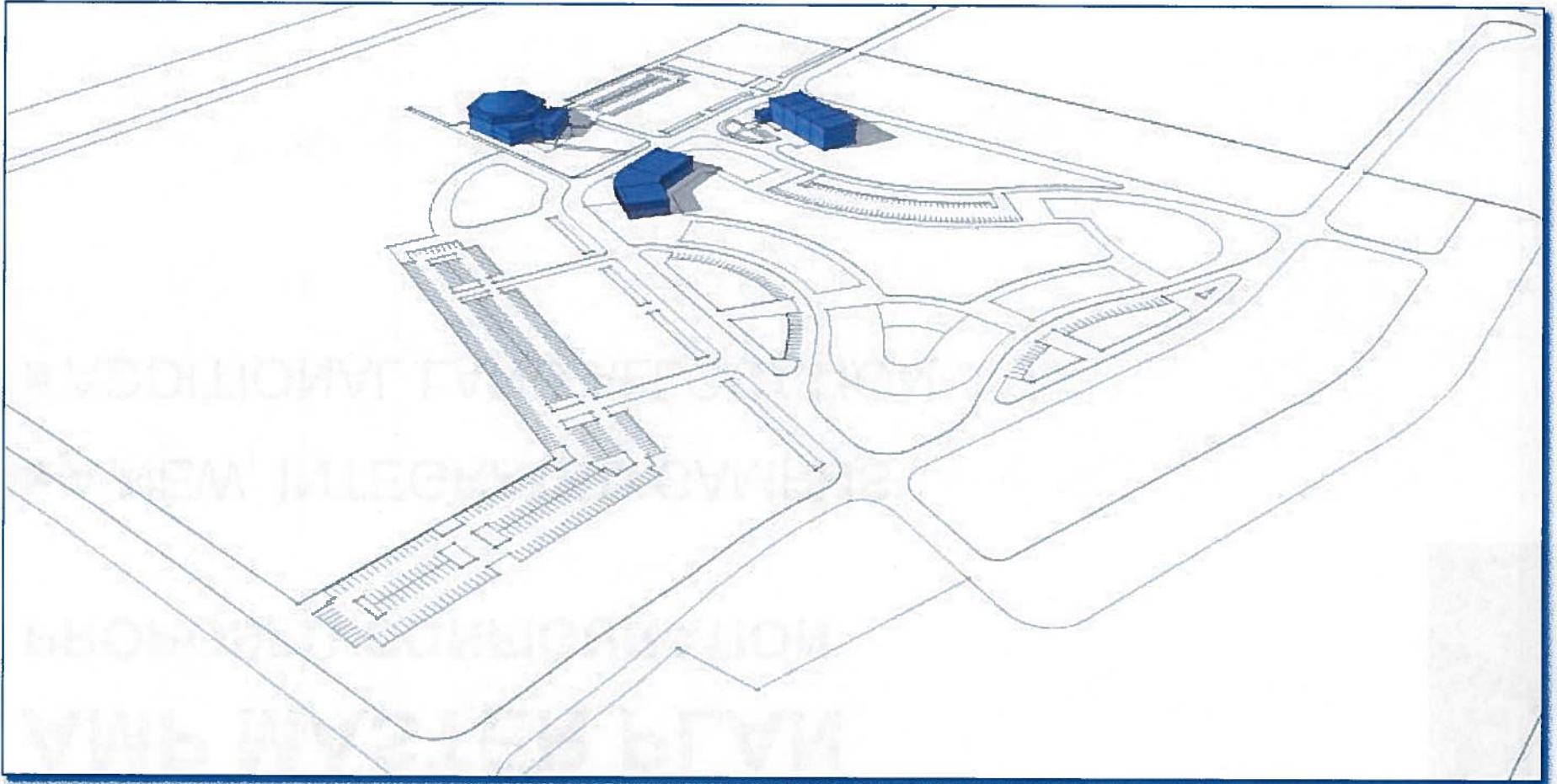

+ AMP MASTER PLAN

PROPOSED CONFIGURATION

- A NEW, INTEGRATED CAMPUS
- ADDITIONAL LAND ALLOCATION

+ AMP MASTER PLAN

PROPOSED INTEGRATED CAMPUS

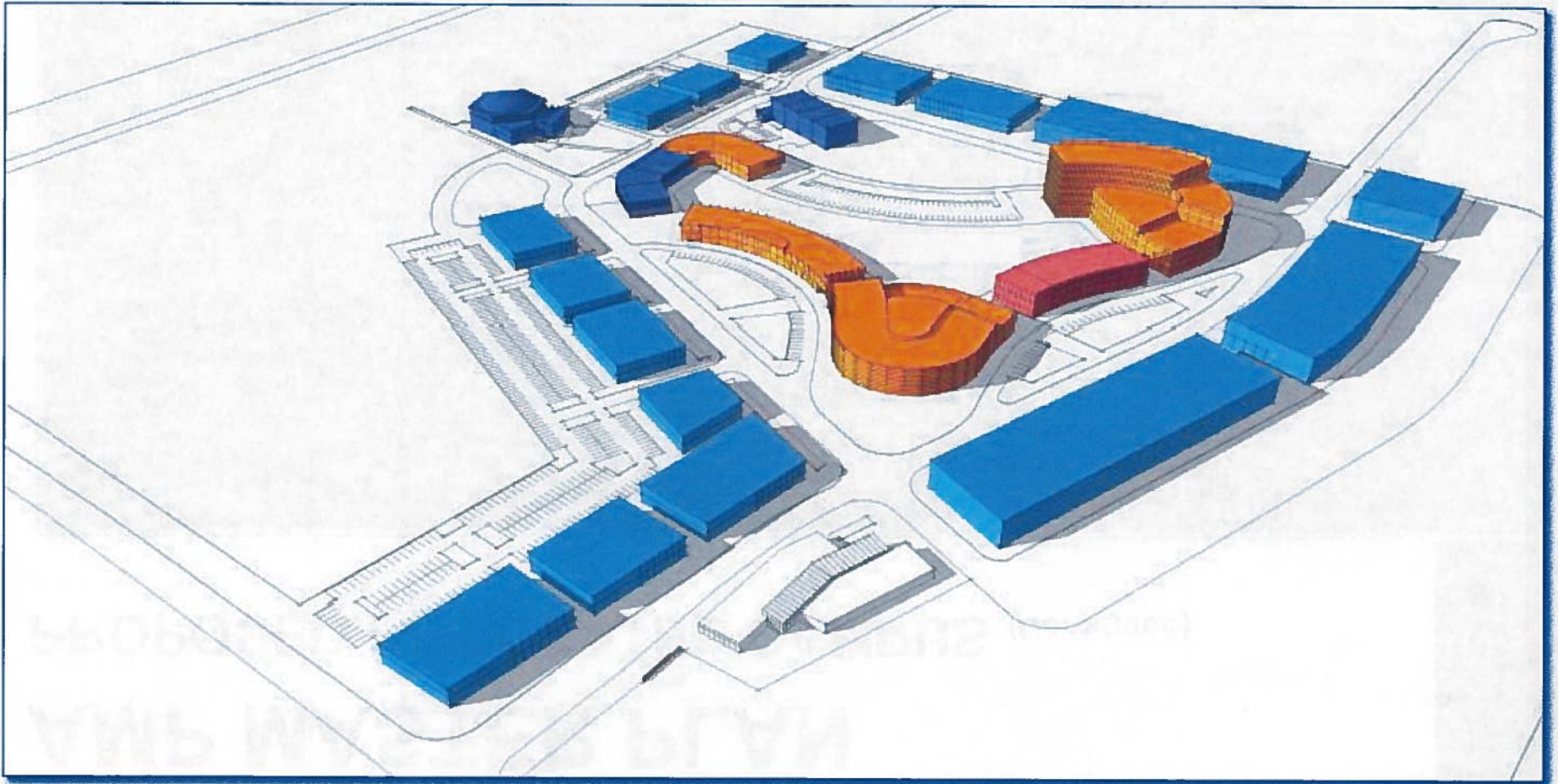

+ AMP MASTER PLAN

PROPOSED INTEGRATED CAMPUS (Continued)

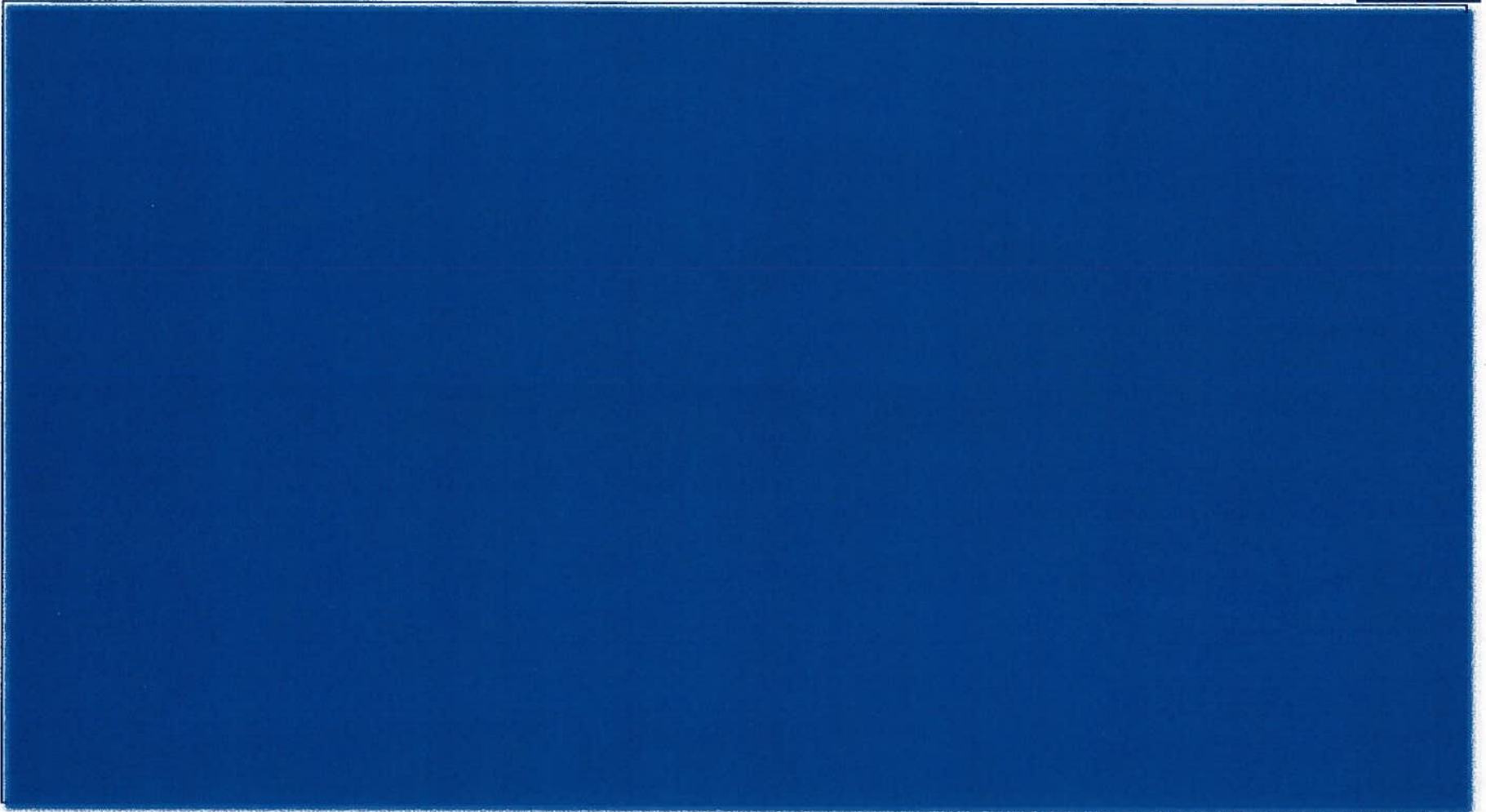

+ AMP MASTER PLAN

PROPOSED INTEGRATED CAMPUS

- CANADIAN FIRST
- MODULAR APPROACH ENSURES FUTURE DEVELOPMENT MATCHES MARKET NEED
- CONTIGUOUS LAYOUT CREATES COMMUNITY, EFFICIENCY, AND CONNECTIVITY
- CLEARLY DELINEATES INDEPENDENT RESEARCH CENTRES, INDUSTRIES, AND THE RD&C HUB
- MODERN, ASTHETIC DESIGN RADIATES RENEWAL, CONFIDENCE, AMBITION.

+ AMP MASTER PLAN

ADDITIONAL LAND ALLOCATION

- PRESERVES THE CAMPUS OPPORTUNITY FOR THIS GENERATION AND THE NEXT
- ENSURES FUTURE DEVELOPMENT IS MEASURED AND CONSISTENT WITH THE PARK'S INTENT
- PROVIDES FUTURE LEADERS WITH FUTURE FLEXIBILITY
- PROVIDES THE COMMUNITY WITH ADDITIONAL ATTRACTION OPTIONS