

London City Map

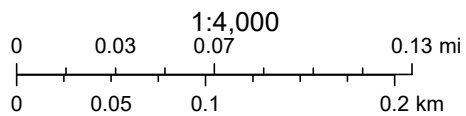

2024-04-04, 3:26:46 p.m.

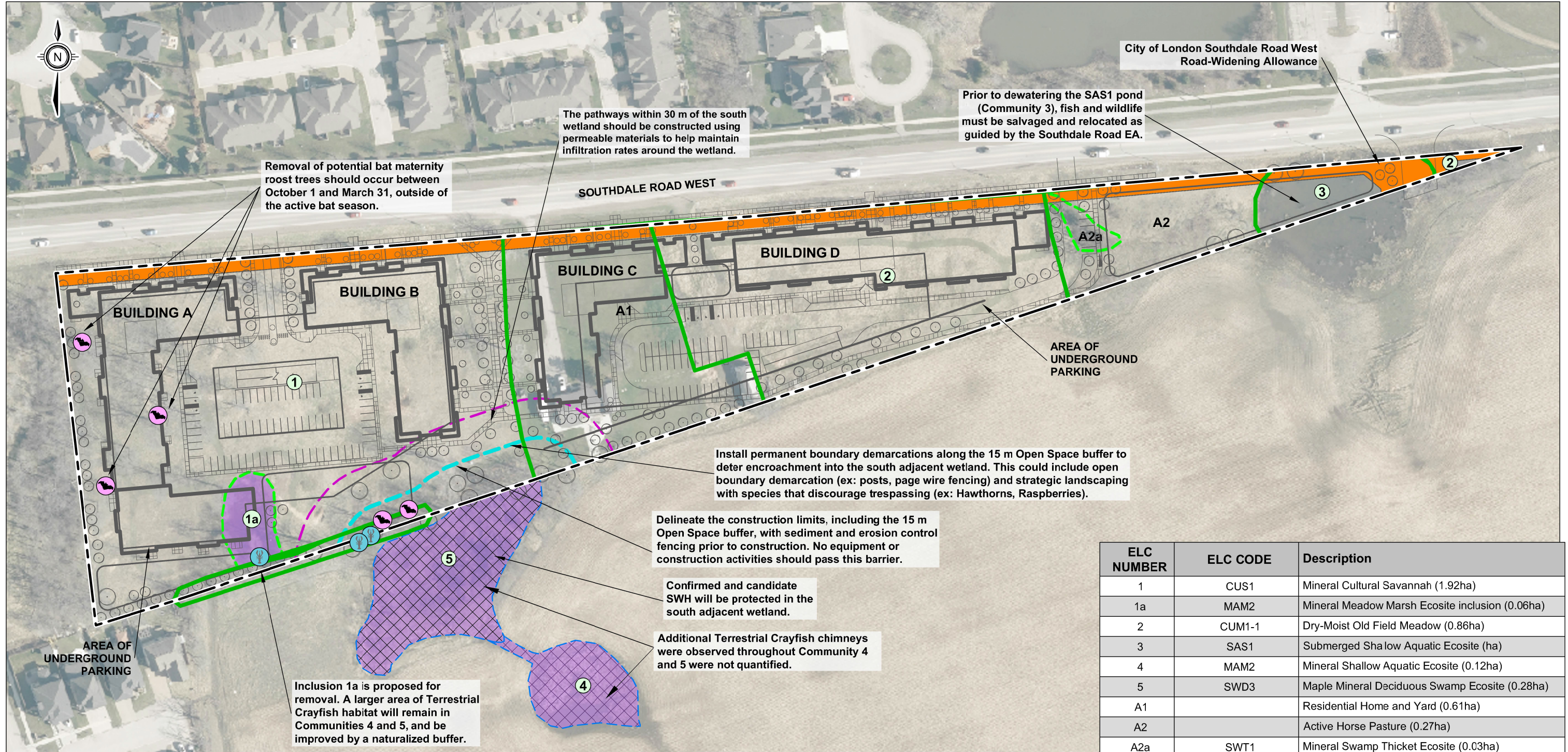



ELC NUMBER	ELC CODE	Description
1	CUS1	Mineral Cultural Savannah (1.92ha)
1a	MAM2	Mineral Meadow Marsh Ecosite inclusion (0.06ha)
2	CUM1-1	Dry-Moist Old Field Meadow (0.86ha)
3	SAS1	Submerged Shallow Aquatic Ecosite (ha)
4	MAM2	Mineral Shallow Aquatic Ecosite (0.12ha)
5	SWD3	Maple Mineral Deciduous Swamp Ecosite (0.28ha)
A1		Residential Home and Yard (0.61ha)
A2		Active Horse Pasture (0.27ha)
A2a	SWT1	Mineral Swamp Thicket Ecosite (0.03ha)

LEGEND

- SUBJECT LANDS
- VEGETATION COMMUNITY
- VEGETATION COMMUNITY (Inclusion)
- WETLAND BOUNDARY INTERPRETATION (MTE)
- RECOMMENDED WETLAND BUFFER
- CITY OF LONDON ROAD WIDENING AREA
- CANDIDATE BAT MATERNITY ROOST TREE
- TERRESTRIAL CRAYFISH EVIDENCE (Chimney or Individual)
- OPEN SPACE BUFFER - 15m (Naturalized)
- 30m BUFFER FROM COMMUNITY 5 WETLAND
- CONFIRMED SWH
- CANDIDATE SWH

REFERENCES

CITY OF 2022 LONDON PARCEL AND AERIAL IMAGERY, CITY OF LONDON ROAD AND WATER NETWORK; MTE WETLAND LETTER, PROJECT No. 46666-101, FEBRUARY 2020; AND ZEDD ARCHITECTURE, SITE PLAN_V13, OCTOBER 3 - 2023.

NOTES

THIS FIGURE IS SCHEMATIC ONLY AND TO BE READ IN CONJUNCTION WITH ACCOMPANYING TEXT.
ALL LOCATIONS ARE APPROXIMATE.



PROJECT
ENVIRONMENTAL IMPACT STUDY
735 SOUTHDALE ROAD WEST
LONDON, ONTARIO

TITLE
MITIGATION MEASURES

Drawn	DCH	Scale	1:1,500
Checked		Project No.	42128-200
Date	2024-02-11	Rev No.	0

11